

## MANUAL

### BRUSHCUTTER CEDRUS WK430X; WK520X



NOTE: Read the operator's manual and all safety precautions before operating the machine. Please keep these instructions for future reference.



## COMPONENT LIST

1. Engine 2. Anti-vibration handle  
3. Anti-vibration handle plate  
4. Right handle  
5. Throttle trigger A  
6. Throttle trigger B  
7. T blade  
8. Adjustable handle support  
9. Handle shaft  
10. Oil mix pot  
11. Flange

12. Clamp  
13. Anti-dust cover  
14. M8 nut  
15. Stopping switch  
16. Left handle  
17. Aluminum working shaft  
18. Spool protection guard  
19. Choke lever  
20. Nylon spool

22. Wrench  
23. Hex key  
24. socket wrench  
25. Belt

## DESCRIPTION OF SYMBOLS

Symbols are used in this manual to attract your attention to possible risks. The safety symbols and the explications which accompany them must be perfectly understood. The warning themselves do not prevent the risks and can not be a substitute for proper methods of avoiding accidents.



This symbol, before a safety comment, indicates a precaution, a warning or a danger. Ignoring this warning can lead to an accident for yourself or for others. To limit the risk of injury, fire or electrocution always apply the recommendations indicated.



Before any use, refer to the corresponding paragraph in the present manual. Read the instruction handbook and follow all warnings and safety instructions



Conforms to relevant safety standards.

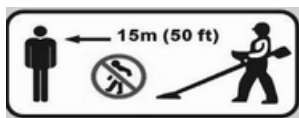

Keep all children, bystanders and helpers 15 meters away from the brush cutter.



The exhaust and other parts of the engine will get very hot during use, do not touch.



Gasoline is very flammable. Avoid smoking or bringing any flame or sparks near fuel.



Beware of thrown objects hit by cutting attachments. Never use without properly mounted blade guard.



Beware of foot injury by cutting attachment



Wear head protection, hearing protection and eye protection when using the device.



Wear robust footwear when using the device.



Wear protective gloves when using the device.



Symbol for refueling the “MIX GASOLINE” on fuel tank cap.

## SAFETY INSTRUCTIONS

This appliance is not intended for use by persons (including children) with reduced physical, sensory or mental capabilities, or lack of experience and knowledge, unless they have been given supervision or instruction concerning use of the appliance by a person responsible for their safety. Children should be supervised to ensure that they do not play with the appliance. 1) Training

- Read the instructions carefully. Be familiar with the controls and the proper use of the appliance.
- This product has been designed for use in cutting grass, and it should never be used for any other purpose.
- Never allow children or people unfamiliar with these instructions to use the appliance. Local regulations may restrict the age of the operator.
- Never mow while people, especially children, or pets are nearby.
- The operator or user is responsible for accidents or hazards occurring to other people or their property.
- Avoid running the engine indoors. The exhaust gases contain harmful carbon monoxide.

## 2) Preparation

- While cutting, always wear substantial footwear and long trousers. Do not operate the
- appliance when barefoot or wearing open sandals. Thoroughly inspect the area where the
- appliance is to be used and remove all stones, sticks, wires, bones, and other foreign objects. Before using, always visually inspect to see that the blades, blade bolts and cutter
- assembly are not worn or damaged. Replace worn or damaged blades and bolts in sets to preserve balance. On multi-bladed appliances, take care as rotating one blade can cause other blades to rotate.
- 

## 3) Operation

- Operate only in daylight or in good artificial light. Avoid operating the appliance in wet grass,
- where feasible. Always be sure of your footing on slopes. Walk, never run. Exercise extreme
- caution when changing direction on slopes. Do not cutting excessively steep slopes. Use
- extreme caution when reversing or pulling the appliance towards you. Never operate the
- appliance with defective guards or shields, or without safety devices. Switch on the motor
- according to instructions and with feet well away from the blade(s). In this case, do not tilt it
- more than absolutely necessary and lift only the part which is away from the operator.
- Always ensure that both hands are in the operating position before returning the appliance to
- the ground. Do not put hands or feet near or under rotating parts. Never pick up or carry an
- appliance while the motor is running. Pull the spark from the socket: · whenever you leave the machine; · before clearing a blockage; · before checking, cleaning or working on the appliance; · after striking a foreign object. Inspect the appliance for damage and make repairs as
- 
- 
- 

necessary;

- if the appliance starts to vibrate abnormally (check immediately).

## 4) Maintenance and storage

- Keep all nuts, bolts, and screws tight to be sure the appliance is in safe working condition.
- Check the grass catcher frequently for wear or deterioration.
- Replace worn or damaged parts for safety.
- For rotary mowers, ensure that only replacement cutting means of the right type are used.
- Never store the equipment with petrol in the tank inside a building where fumes can reach an open flame or spark;
- Allow the engine to cool before storing in any enclosure;
- To reduce the fire hazard, keep the engine, silencer, battery compartment and petrol storage area free of grass, leaves, or excessive grease;
- If the fuel tank has to be drained, this should be done outdoors.

## SPECIAL SATETY WARNING

1. Grip the handles of the brush cutter firmly with both hands. If you suspend the work, place the throttle into the idling position.
2. Always be sure to maintain a steady, even posture while working
3. Maintain the speed of the engine at the level required to perform cutting work and never raise the speed of the engine above the necessary level.
4. If the grass gets caught in the blade during operation, or if you need to check the unit or refuel the tank always be sure to turn off the engine.
5. If the blade touches a hard object like a stone immediately stop the engine and check if something is wrong with the blade. If so, replace the blade with a new one.
6. If someone calls out while working, always be sure to turn off the engine before turning around.



7. Never touch the spark plug or plug cord while the engine is in operation. Doing so may result in being subjected to an electrical shock.

8. Never touch the muffler, spark plug or other metallic parts of the engine while the engine is in operation or immediately after shutting down the engine. Doing so may result in serious burns.

9. When you finish cutting in one location and wish to continue working in another spot, turn off the engine and turn the machine to have the blade facing away from your body.



10. Check that the cutting attachment stopped turning under the engine idle before starting to use the machine.

## Intended use

**This brush cutter has been designed for cutting grass. Any other use is not permitted.** The brush cutter is suitable for private use in the garden only, brush cutter for private use are those which are used for cutting grass in the garden, however not for cutting grass in public parks, playing fields or on farms or in forest. **Non-permitted users:** Persons who are not familiar with the operating manual, children, young people under the age of 16 as well as persons under the influence of alcohol, drugs or medication must not operate the unit.

**Working hours for gasoline brush cutter** While it is permitted to use a brush cutter at any time, operators should always show due consideration to others living nearby.

## ASSEMBLY

When assembling this machine, please follow the instructions for assembly printed.

### 1. Assemble the handle

Use the under and upper adjustable handle bar to hold the handle tube, put the spring on the under bar hole, and use the screw to fix the bar and tube together.



### 2. Assemble the safe guard.

Place the guard on the **fixture**; Assemble and tighten the screws.

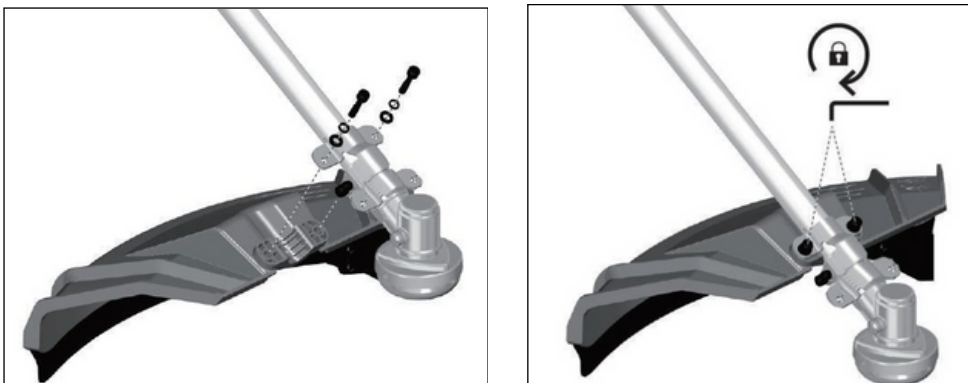

**Warning!** Use only original manufacturer's replacement parts, accessories and attachments. Failure to do so can cause poor performance, possible injury and may void your warranty. Never use the machine without the guard assembled!

### 3. Assemble the cutting head.

#### Nylon head

**3.1 Release the nut.** Line up the two holes of flange and shield, use one screw driver to hold the flange as below and turn the socket wrench clockwise, the nut will be released.



**3.2 Fit the Nylon cutting head.** Remove another shield after release the nut. Still hold the flange, take the Nylon cutting head on the shaft and rotate counter-clockwise, the Nylon cutting head is fitted.



**Release the Nylon cutting head.** Use screw driver to hold flange and then rotate the Nylon cutting head clockwise till it is well fixed, it will be replaced.





### Three tooth blade

**3.3 Fit the blade.** Take the outer flange off after release the nut, then put the blade, outer flange, shield and nut according to priority as below picture. Note the blade rotation direction needs be same as below picture. Use screw driver to hold flange and tighten nut counter-clockwise, ensure the nut is tightened enough.



**Release blade.** Use screw driver to hold flange and release nut, the blade can be took off.

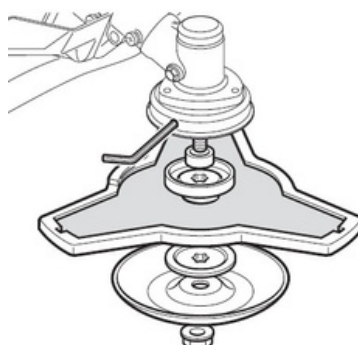

### Warning!

Please make sure the cutting head has been assembled correctly before use!

**Note:** The packaging material is made of recycle materials. Dispose of packaging materials in accordance with regulations.

**Release blade.** Use screw driver to hold flange and release nut, the blade can be took off.

### Warning!

Please make sure the cutting head has been assembled correctly before use!

**4. Fit and adjust the belt.** The design and type of carrystrap may vary.

- Put on the shoulder strap (1).
- Adjust the length of the belt so that the spring hook (2) is roughly a hand's width below your right hip.

**PLEASE NOTE:** This carry strap has a safety device allowing you to immediately disconnect the strap from the machine in an emergency. To do so, pull forcefully on the red pull tab (3) on the strap. This disconnects the strap from the holding fixture immediately.

**NOTE:** Never start the motor without the carry strap attached to the machine well.



## OPERATION

### Filling with fuel



**DANGER!**

#### **Danger of injury!**

Fuel is explosive!

- Turn off and cool the motor down before filling the tank with fuel.
- You must observe all safety instructions relating to handling fuel.



**ATTENTION!**

#### **Risk of device damage!**

The device is supplied without motor or gearbox oil.  
Before operating, you must fill it with fuel.

Never use oil for 4-cycle engine use or water-cooled 2-cycle engine. It can cause spark plug fouling, exhaust port blocking or piston ring sticking. Mixed fuels, which have been left unused for a period of one month or more, may clog the carburetor or result in the engine failing to operate properly. Put remaining fuel into an airtight container and keep it in the dark and cool room.

**Mix a regular grade gasoline (leaded or unleaded, alcohol-free) and a quality-proven motor oil for air-cooled 2 cycle engines.**

### **RECOMMENDED MIXING RATIO**

**GASOLINE: OIL= 40: 1**

**WARNING!** Take care of the emission of exhaust gases. Always shut off engine before fueling. Never add fuel to a machine with a running or hot engine. Take care of fire!

**WARNING!** Never smoke whilst refueling and avoid inhaling the petrol fumes.

**WARNING!** Carefully open the tank top as pressure could have formed inside.

**Before refueling:**

- Shake the fuel mixture container well.
- Place the machine on a flat stable surface, with the fuel tank cap facing upwards.
- Clean the fuel tank cap and the surrounding area to avoid any dirt from entering the tank during refilling.
- Carefully open the fuel tank cap to allow the pressure inside to decrease gradually. Use a funnel to refill and avoid filling the tank to the brim.
- Unscrew the tank cap and remove it.
- Pour in the fuel carefully, avoid spilling.
- Screw the tank cap on firmly by hand.

**Draining fuel**

- Hold a collection container beneath the fuel drain bolt.
- Unscrew the tank cap and remove it.



- Allow the fuel to run out completely.
- Screw the tank cap on firmly by hand.

**WARNING! Always close the fuel tank cap firmly.**

**WARNING! Immediately clean all traces of fuel which may have dripped on the machine or the ground and do not start the engine until the petrol fumes have dissipated.**

**Start on the unit**

Do not start the unit until it has been completely assembled. Before switching on the unit, always checking the oil

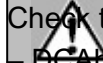
**Check before use!****Danger of injury!**

Check the safe condition of the device:

- Do not operate the device unless you did not find any faults. If a part has become defective, make sure to replace it before you use the device again.
- Check the device for visual defects.

- Check that all parts of the device have been securely fitted.
- Check that all safety devices are in proper condition.

**Danger of injury!**

Before starting work, always check the ground and remove all objects which could be thrown by the device.

Once the machine has been set up properly, start the engine as follow:

**The engine switch is automatically on the ON position always.** 1. Attention When the brush cutter is used and started for the very first time, the final user is warmly recommended to push the primer pump for 10 times at least, so has to obtain the best performance of the equipment for future use as well.



2. Adjust the choke lever to (off) position.



3. Pull the starter grip slowly for 10 - 15 cm until the engines starts.



Please note that the choke lever is automatic, once you press the throttle trigger, it would return to "on" automatically.

4. Press the throttle trigger A and B, the machine will start to rotary and work.



5. If use Nylon cutter, before cutting, need to bump it to feed line firstly.

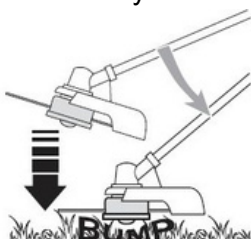

6. If you need stop cutting head working, release the throttle trigger A and B.

If any problem occurs, press the engine switch, the machine will stop running.



Please note that the stopping switch is always stay on “on” if you don’t press it, so if the machine is hot, the customer can restart the machine by pulling the starter grip directly.

7 If any emergency occurs, you can release the machine by pull the pin on the belt.



8. **WARNING!** Do not use the machine for sweeping, tilting the cutting line head. The power of the engine could throw objects and small stones 15 meters or more, causing damage or injuries to people.

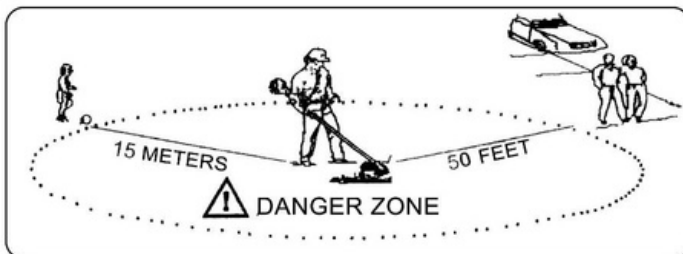

No person except operator allowed 15 meters radius danger zone. Eye, ear, face, foot, leg and body protection must be worn by operator.

Persons in zone or risk beyond danger zone should wear eye protection against thrown objects. Risk diminishes with distance from danger zone

**Note:**

1. Do not start the motor in tall grass
2. While mowing, lay the connection cable safely on footpaths and on areas which have already been mown.
3. When the engine has been switched off, the cutter continues running for several seconds therefore do not get close to the cutting head of the brush cutter until the cutter has come to a standstill!

## ROUTINE MAINTENANCE

Correct maintenance is essential to maintain the original efficiency and safety of the machine over time.

**Before performing any maintenance or cleaning work, always turn off the engine.**

1. Do not spray the unit with water. Ingress of water may damage the engine and electrical connection.
2. Clean the unit with a cloth, hand brush, etc.

**WARNING!** During maintenance operations:

- Remove the spark plug cap.
- Wait until the engine is sufficiently cold.
- Never dispose of oils, fuel or other polluting materials in unauthorized places

Maintenance schedule			
	12 hours of use	24 hours of use	36 hours of use
Air filter	clean	Clean	Replace
Spark plug	check	Clean	Replace

**Expert inspection is required:**

- a) If the grass trimmer strikes an object.
- b) If the motor stops suddenly
- c) If the nylon cutter is damaged
- d) If the gears are damaged.

Replacing and re-cleaning the nylon spool at the end of the trimming season. Always re-cleaned the nylon spool or, if required, replace the nylon spool with a new one. Always have the nylon spool re-cleaned or replaced by a customer service center.

## STORAGE

At the end of each working session, carefully clean the machine of dust and debris, and make sure that there are no damaged parts, replacing any faulty parts. The machine must be stored in a dry place away from the elements and with the cover correctly fitted.

## CLEANING THE ENGINE AND THE SILENCER

To reduce fire risks, periodically clean the cylinder fins with compressed air and clear the silencer area to get rid of sawdust, branches, leaves or other debris.

## STARTING UNIT

To avoid overheating and damage to the engine, always keep the cooling air vents clean and free of sawdust and debris. If you notice signs of wear on the starter cable, contact your Dealer for a replacement.

## NUTS AND SCREWS

Periodically check that all the nuts and screws are securely tightened and the hand grips are tightly fastened.

### Change and clean the spark plug

- Periodically remove and clean the spark plug using a metal brush to get rid of any deposits.
- Check and reset the correct distance between the electrodes.
- Replace the spark plug and fasten it firmly using the supplied wrench.
- The spark plug must be replaced with one with the same characteristics whenever the electrodes have burnt or the insulation has worn, and in any case every 100 working hours.



### Clean the air filter

**IMPORTANT** Cleaning the air filter is essential to guarantee the efficiency and duration of the machine. Do not work with a damaged filter or without a filter, as this could permanently damage the engine. It must be cleaned after every 12 working hours.

Clean the filter as follows:

- Loosen the screws, remove the cover and the filter element
- Clean the filter element with air gun or brush. Do not use water, petrol or other solvents.
- Leave the filter to dry in the open air.
- Fit the filter element and the cover back on, tightening the screws again



**Warning!**

**Never run the engine without the air filter element installed.**

### Angle transmission

Lubricate with lithium-based grease. Remove the screw (1) and put in the grease, turning the shaft manually until grease emerges, and then re-fix the screw (1).

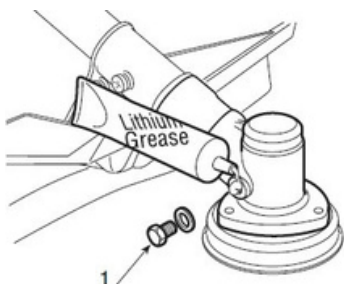

## Head line replacement (see below pics.)

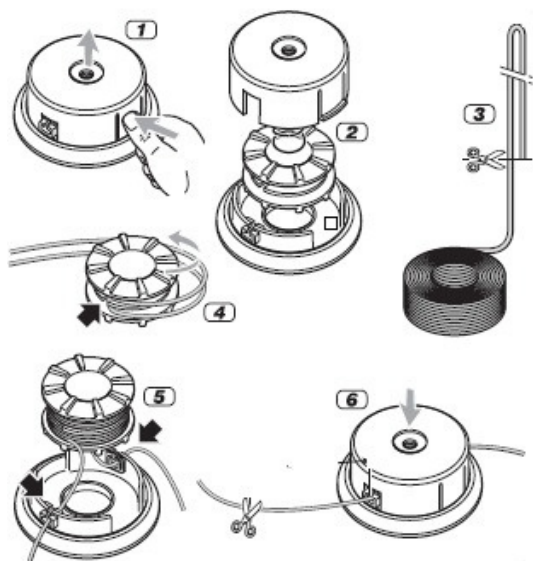

## SHARPENING THE LINE CUTTING KNIFE

- Remove the line cutting knife (A) from the guard (B) by unscrewing the screws (C).
- Fix the line cutting knife in a vice and sharpen it using a flat file, being careful to retain the original cutting angle.
- Refit the knife on the guard.

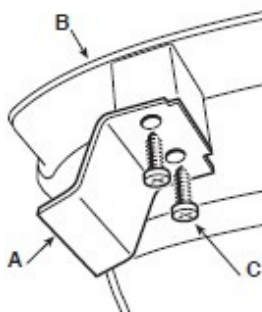

## TROUBLESHOOTING

**Before performing any maintenance or cleaning work, always turn off the engine and wait until the cutter has come to a standstill.**

### 1)The engine will not start or will not keep running

- Reassemble the nylon cutter.
- Check that weather there is no fuel or be used out.
- Incorrect starting procedure-- Follow the instructions
- Dirty spark plug or incorrect distance between the electrodes- Check the spark plug
- Air filter clogged- Clean and/or replace the filter
- Carburator problems- Contact your Dealer

### 2)The engine starts but is lacking in power

- Have nylon spool replaced (customer service center)



- 
- Air filter clogged-- Clean and/or replace the filter
  - Carburetor problems- Contact your Dealer

**3) The engine runs irregularly and lacks in power when revved**

- Dirty spark plug or incorrect distance between the electrodes- Check the spark plug
- Carburetor problems-- Contact your Dealer

**4).The engine makes too much smoke**

- Incorrect composition of the fuel mixture- Prepare the fuel mixture according to the instructions.
- Carburetor problems- Contact your Dealer

**5) The cutting device must not move when the engine is running idle**

- Incorrect carburetor regulation - Contact your Dealer

**6)The machine starts to vibrate abnormally**

-Damaged or loose parts- Stop the machine and disconnect the spark plug cable Inspect for damage. Check for and tighten any loose parts. Have all checks, repair work and replacements carried out by a specialized Center only.

**7) If the temperature of machines is too high:**

---insure the machines have rest at regular time.

Faults which cannot be rectified with the aid of this table may be rectified by a specialist company only (customer service center).

## SPECIFICATIONS

Type	WK430x	WK520x 51.7CC
Engine displacement	42.7CC	1.50KW 700ml
Rated motor power	1.30KW	Φ28mm 450mm
Volumes of fuel tank	700ml	Φ2.8mm
Shaft diameter	Φ28mm	255mm 1.4mm
Nylon Cutting width	450mm	9600min-1
Nylon line	Φ2.8mm	9600min-1
Blade cutting width	255mm	3000±300min-1
Blade thickness	1.4mm	7800min-1
Maximum engine speed with nylon head	9600min-1	7800min-1 40:1
Maximum engine speed with 3T blade	9600min-1	10.5 kg
Idling speed	3000±300min-1	117dB(A)
Maximum brush cutter rotational speed	7800min-1	
Maximum grass trimmer rotational speed	7800min-1	
Gasoline:Oil ratio	40:1	
Net weight(including the engine)	10.5 kg	
Sound power level, LWA	115dB(A)	