

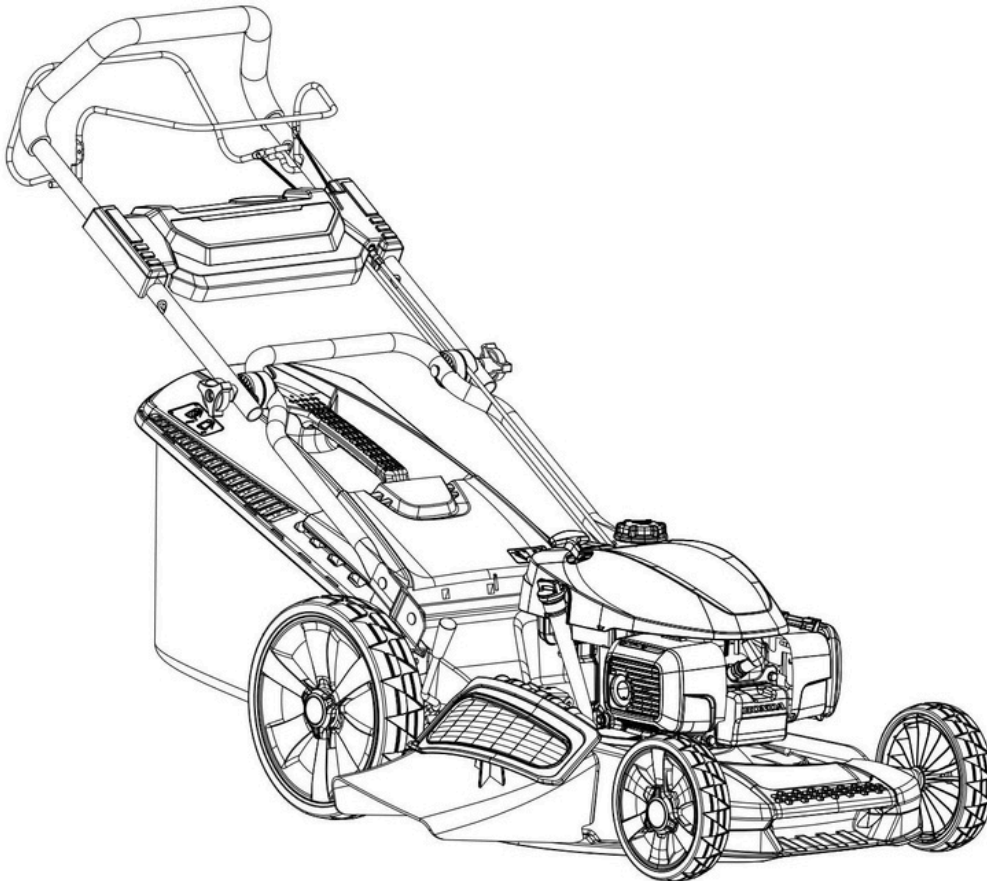

HAHN A SYN s.r.o.
Lelkova 186/4
747 21 Kravaře
CZECH REPUBLIC
info@hahn-profi.cz

Hahn & Sohn GmbH
Janahof 53
93413 Cham
Deutschland
hahn@hahn-sohn.de

USER MANUAL



Lawn mower

MODEL NO.:



CEDKS53S-H AL

SERIAL NO:

The model number and serial number can be found on the nameplate.
Write them down and keep them in a safe place.



PREFACE

This user manual contains the most important information about the device, its construction, functions and use. Before starting work, read the user manual carefully. Safe and correct use will help you achieve the best results.

All information contained in the manual is based on the latest product data on the date of printing. Due to the continuous improvement of devices and the introduction of changes to them, the user manual may differ from the actual condition of the device.

The manufacturer reserves the right to introduce changes to the product at any time. Product parameters may change without notice. It is prohibited to copy and duplicate the user manual and its elements without the manufacturer's consent.

This user manual should be treated as an integral part of the device and in the event of transferring the device to third parties or reselling it should be transferred together with the device.

Operating the device in accordance with the user manual and the messages contained therein is crucial to maintaining the long-term and safe operation of the device and to meeting the expectations of users. Failure to read, understand or follow the user manual may lead to serious injury and damage to the device.

CEDRUS is not responsible for any errors in the printing of this manual, which do not directly affect the way the device is used, and only concern detailed technical or descriptive data. Devices are modernized during production, therefore some data contained in this manual may differ from the actual data, which also does not affect the way the device is used.

Photos and illustrations contained in this user manual are for illustrative purposes, and the physical condition of the device may differ from the actual condition.



Information marked in this way indicates actions that the user should take to prevent situations that could lead to damage to the device, property damage, serious injury to the user and others, or in extreme cases, death.

Keep this manual for future reference.

It is recommended that you record the serial number of the device along with the date of purchase in the field below so that you always have this information at hand.

SERIAL NO.: _____

DATE OF PURCHASE: _____

The model and serial number of your appliance can be found on the nameplate on the back of the casing.

Retain this information and your proof of purchase for future reference.

Contents

To the User	1
Record Product Information	1
Important Safe Operation Practices	1
General Operation	2
Slope Operation	3
Children.....	4
Service.....	4
Do Not Modify Engine	5
Slope Gauge	5
Assembly & Set-Up	6
Content of Carton	7
Assembly.....	7
Cup Holder	8
Set-Up	10
Operation.....	11
Starting Engine.....	11
Stopping Engine	11
Engine Speed Control(For Throttle Control Model).....	11
Self Propelled Function.....	2
Using Your Mower	2
Maintenance	3
General Recommendations	3
Engine Tipping	3
Lubrication	3
Clean the Mower	3
Engine Care	4
Cable Maintenance.....	4
Blade Care	4
Off-Season Storage	6
Troubleshooting	7

To the User

Welcome to your new lawn mower! To ensure safe and easy use of your machine, please read this entire manual carefully before operating it. This manual provides detailed instructions on how to properly set up, use, and maintain your lawn mower. It is crucial that you and any other individuals who will be operating the machine follow the recommended safety practices at all times to prevent personal injury or damage to property.

Please note that this Operator's Manual may cover a range of product specifications for various models, and the characteristics and features discussed may not apply to all models. We reserve the right to make changes to product specifications, designs, and equipment without prior notice or obligation.

Throughout this manual, all references to the right and left sides of the machine are observed from the operating position to ensure proper orientation.

Please keep in mind that the engine manufacturer is responsible for all engine-related issues, such as performance, power-rating, specifications, warranty, and service. For more information, please refer to the engine manufacturer's Owner's/Operator's Manual, which is packed separately with your machine.

IMPORTANT NOTICE:

1. Machines may not be fully assembled and may be sold in cartons. It is the user's responsibility to ensure that the assembly instructions in this manual are followed exactly.
2. Even if the machine is pre-assembled, the user must still check to ensure that it has been correctly assembled before every use.
3. Before starting the machine, the user must carefully inspect it to ensure that it is in good working condition. Do not operate the machine if it is damaged or not functioning properly.

Record Product Information

To order parts or seek technical help, the following information is necessary:

1. The required information can be found on the rear flap or rear area of the chassis.
2. Additional information including DATE MANUFACTURED may be obtained from your local dealer.

Model: _____ Date Manufactured(DD/MM/YYYY):

_____ Date Purchased(DD/MM/YYYY):

Important Safe Operation Practices

DANGER: This machine was designed to be operated in accordance with the safe operation practices outlined in this manual. As with any type of power equipment, operator error or carelessness can result in serious injury. This machine is capable of amputating fingers, hands, toes, and feet, and can also throw objects with great force. Failure to adhere to the following safety instructions could result in serious injury or even death.

General Operation

1. Please read this manual thoroughly before starting to assemble the machine. Make sure to carefully follow all instructions provided in the manual and on the machine before using it. Store this manual in a secure location for future reference and if replacement parts are needed.
2. Ensure that you have a thorough understanding of the controls and correct usage of the machine before operating it.
3. This machine is a powerful tool that requires careful handling. Please use caution at all times. Its purpose is to mow grass, and it should not be used for any other activities.
4. This machine is not intended for use by children under 14 years of age. Individuals aged 14 and above should carefully read and comprehend the operating instructions and safety guidelines provided in this manual and on the machine. They should also receive appropriate training and supervision from an adult before operating the machine.
5. This machine should only be operated by responsible individuals who are knowledgeable and follow the rules of safe operation.
6. Before using the equipment, carefully examine the area where it will be operated. Clear away any stones, sticks, wire, bones, toys or other debris that could cause tripping or be hurled by the blade. Flying objects can result in severe injury, so exercise caution.
7. When mowing, plan your pattern carefully to prevent debris from being discharged towards roads, sidewalks, bystanders, or other areas. Be sure to avoid discharging material against walls or obstructions, as it may bounce back towards the operator and cause injury.
8. Remain in the designated operator zone behind the handles to minimize the risk of blade contact or injury from thrown objects. Make sure children, bystanders, helpers, and pets are at least 75 feet away from the mower during operation. If anyone enters the area, stop the machine immediately.
9. It is crucial to wear safety glasses or goggles at all times while operating the machine or making any adjustments or repairs. This will provide protection to your eyes against any thrown objects that may cause serious eye injuries, especially those that ricochet.
10. It is recommended to wear durable work shoes with rough soles and close-fitting clothing, such as pants and shirts that cover the arms and legs. Steel-toed shoes are also recommended. Operating the machine in bare feet, sandals, or lightweight shoes like canvas should be avoided.
11. Keep your hands and feet away from rotating parts and underneath the cutting deck. Blades can cause serious injuries, including amputation of fingers, hands, toes, and feet.
12. Operating the machine without a discharge cover, or with a damaged one, can result in injuries from blade contact or thrown objects.
13. Falls caused by slipping or tripping can result in serious injuries if the mower is pulled over the foot. If you are falling, do not hold on to the mower; release the handle right away.
14. Avoid pulling the mower towards you while walking. If you need to move the mower away from a wall or obstacle, take the following precautions:
 - a. Step away from the mower to extend your arms fully.
 - b. Make sure you are balanced and have secure footing.
 - c. Pull the mower slowly, no more than halfway towards you.
 - d. Repeat these steps as necessary.
15. Operating the mower while under the influence of alcohol or drugs is strictly prohibited.
16. Before starting the engine, do not activate the self-propelled feature on machines that are equipped with it.
17. The blade control is a safety device. Never attempt to bypass its operation. Doing so makes the safety

device inoperative and may result in personal injury through contact with the rotating blade. The blade control must operate easily in both directions and automatically return to the disengaged position when released. 18. Do not try to disable or bypass the blade control, as it is a safety feature. Such action can render the safety device useless and lead to serious injury from the spinning blade. The blade control should work smoothly in both directions and automatically return to the disengaged position when released. 19. Only mow during daylight hours or when there is good artificial lighting. Walk, never run, while operating the mower. 20. Make sure to disengage the blade when you need to cross gravel drives, walks or roads. 21. In case of abnormal vibrations, immediately turn off the engine and investigate the cause. Vibrations are usually an indication of a problem that needs to be addressed. 22. Always turn off the engine and wait for the blade to come to a complete stop before removing the grass catcher or clearing the chute. Even after the blade control is released, the cutting blade may continue to rotate for a few seconds. Never put any part of your body near the blade area until you are certain the blade has stopped rotating. 23. Always ensure that safety protective devices such as the trail shield, discharge cover, grass catcher, and blade control are in place and working correctly before operating the mower. Do not operate the mower if any safety device is damaged as it can cause personal injury. 24. The muffler and engine of the mower can become hot and cause burns. Avoid touching them while in operation. 25. Never attempt to adjust the wheel or cutting height while the engine is running. 26. Use only manufacturer-made parts and accessories specifically designed for this machine. Failure to do so can result in personal injury. 27. When starting the engine, pull the cord slowly until you feel resistance, then pull rapidly. Avoid rapid retraction of the starter cord (kickback) as it can pull your hand and arm toward the engine faster than you can let go, resulting in broken bones, fractures, bruises, or sprains.

Slope Operation

Slopes present a significant risk for slip and fall accidents that may result in severe injuries. Therefore, extra caution must be taken when operating the machine on slopes. The machine's weight and gravity can speed it up when going downhill, so it's essential to be prepared to maintain control of the machine. To ensure your safety, always use the slope gauge included in the manual to measure slopes before operating the machine on sloped or hilly areas. Do not mow slopes greater than 15 degrees.

Do:

1. Always mow across the face of slopes and never up and down to avoid losing control.
2. Exercise extreme caution when changing direction on slopes; turn uphill, not downhill.
3. Watch out for holes, ruts, rocks, hidden objects, or bumps that can cause you to slip or trip. Tall grass can obscure obstacles.
4. Always make sure of your footing. If you feel you are losing your balance, release the blade control handle immediately.

Do Not:

1. Do not mow near drop-offs, ditches, or embankments as you could lose your footing or balance.
2. Do not mow on wet grass. Unstable footing could cause slipping.

Children

Tragic accidents can occur if the operator is not alert to the presence of children, who may be attracted to the mower and the mowing activity. To ensure the safety of children, follow these guidelines:

1. Keep children out of the mowing area and under the watchful care of a responsible adult other than the operator.
2. Be alert and turn off the mower if a child enters the area.
3. Before and while moving backwards, look behind and down for small children.
4. Use extreme caution when approaching blind corners, doorways, shrubs, trees, or other objects that may obstruct your vision of a child who may run into the mower.
5. Keep children away from hot or running engines, as they can suffer burns from a hot muffler.
6. Never allow children under 14 years of age to operate this machine. Children aged 14 and over should read and understand the instructions and safe operation practices in this manual and on the machine and be trained and supervised by an adult.
7. After stopping the engine, remove the Electric Start Push Key (if equipped) and keep it in a safe place out of the reach of children.

Service

Safe Handling Of Gasoline

1. Gasoline should be handled with extreme care to avoid personal injury or property damage since it is extremely flammable, and its vapors are explosive. If gasoline spills on you or your clothes, it can ignite and cause serious personal injury. Therefore, it is essential to wash your skin and change clothes immediately.
2. Only approved gasoline containers should be used.
3. Gasoline containers should not be filled inside a vehicle, or on a truck or trailer bed with a plastic liner. They should be placed on the ground away from the vehicle before filling.
4. Gas-powered equipment should be removed from the truck or trailer and refueled on the ground. If this is not possible, then refueling should be done from a gasoline dispenser nozzle, but on a trailer with a portable container.
5. The nozzle should remain in contact with the rim of the fuel tank or container opening throughout the refueling process, and a nozzle lock-open device should not be used.
6. All sources of ignition such as cigarettes, cigars, pipes, etc., should be extinguished.
7. Machines should not be fueled indoors since flammable vapors accumulate in the area.
8. Gas cap should not be removed, nor fuel added while the engine is hot or running. The engine should be allowed to cool for at least two minutes before refueling.
9. The fuel tank should not be overfilled. It should be filled to no more than 1 inch below the bottom of the filler neck to provide for fuel expansion.
10. The gasoline cap should be replaced and securely tightened.
11. Gasoline spills should be wiped off the engine and equipment, and the machine moved to another area. The engine should not be started until five minutes have passed.

12. The machine or fuel container should not be stored near an open flame, spark, or pilot light such as on a water heater, space heater, furnace, clothes dryer, or other gas appliances.
13. To reduce the fire hazard, the machine should be kept free of grass, leaves, or other debris build-up. Oil or fuel spillage should be cleaned up, and fuel-soaked debris should be removed.
14. The machine should be allowed to cool for at least five minutes before storing.

General Service

1. Engines should never be run indoors or in a poorly ventilated area since engine exhaust contains carbon monoxide, an odorless and deadly gas.
2. Before cleaning, repairing, or inspecting, it should be ensured that the blade and all moving parts have stopped. The spark plug wire should be disconnected and grounded against the engine, and Electric Start Push Key (if equipped) should be removed to prevent unintended starting.
3. The blade and engine mounting bolts should be checked at frequent intervals for proper tightness. The blade should also be visually inspected for damage (e.g., bent, cracked, worn), and replaced with the original equipment manufacturer's (O.E.M.) blade only.
4. Mower blades are sharp and can cut. It is recommended to wrap the blade or wear gloves and use extra caution when servicing them.
5. All nuts, bolts, and screws should be kept tight to ensure the equipment is in safe working condition.
6. Safety devices should not be tampered with, and their proper operation should be checked regularly.
7. After striking a foreign object, the engine should be stopped, the spark plug wire disconnected and grounded against the engine, and the mower thoroughly inspected for any damage. The damage should be repaired before starting and operating the mower.
8. The wheel or cutting height adjustment should not be attempted while the engine is running.
9. Grass catcher components, discharge cover, and trail shield should be checked frequently as they are prone to wear and damage. This can lead to the exposure of moving parts or the potential for objects to be thrown. To ensure safety, it is important to replace any damaged components immediately with original equipment manufacturer's (O.E.M.) parts only.
10. The engine's governor setting should not be changed or over-speeded. The governor is responsible for controlling the maximum safe operating speed of the engine.
11. It is recommended to check the fuel line, tank, cap, and fittings regularly for cracks or leaks. If any damage is found, the parts should be replaced immediately.
12. Do not attempt to crank the engine with the spark plug removed.
13. Safety and instruction labels should be maintained or replaced as necessary.

Do Not Modify Engine

To prevent the risk of severe injury or death, refrain from modifying the engine in any manner. Adjusting the governor setting can result in an uncontrolled engine and may cause it to run at hazardous speeds. It's crucial to never alter the factory settings of the engine governor.

Slope Gauge

Slopes are a major factor related to slip and fall accidents which can result in severe injury or death. The machine is heavy and can speed up when going downhill. Be prepared to maintain control of the machine.

To avoid loss of control, operate across slopes, not up and down. When turning, turn uphill, not down. Do not operate machine on slopes in excess of 15 degrees.

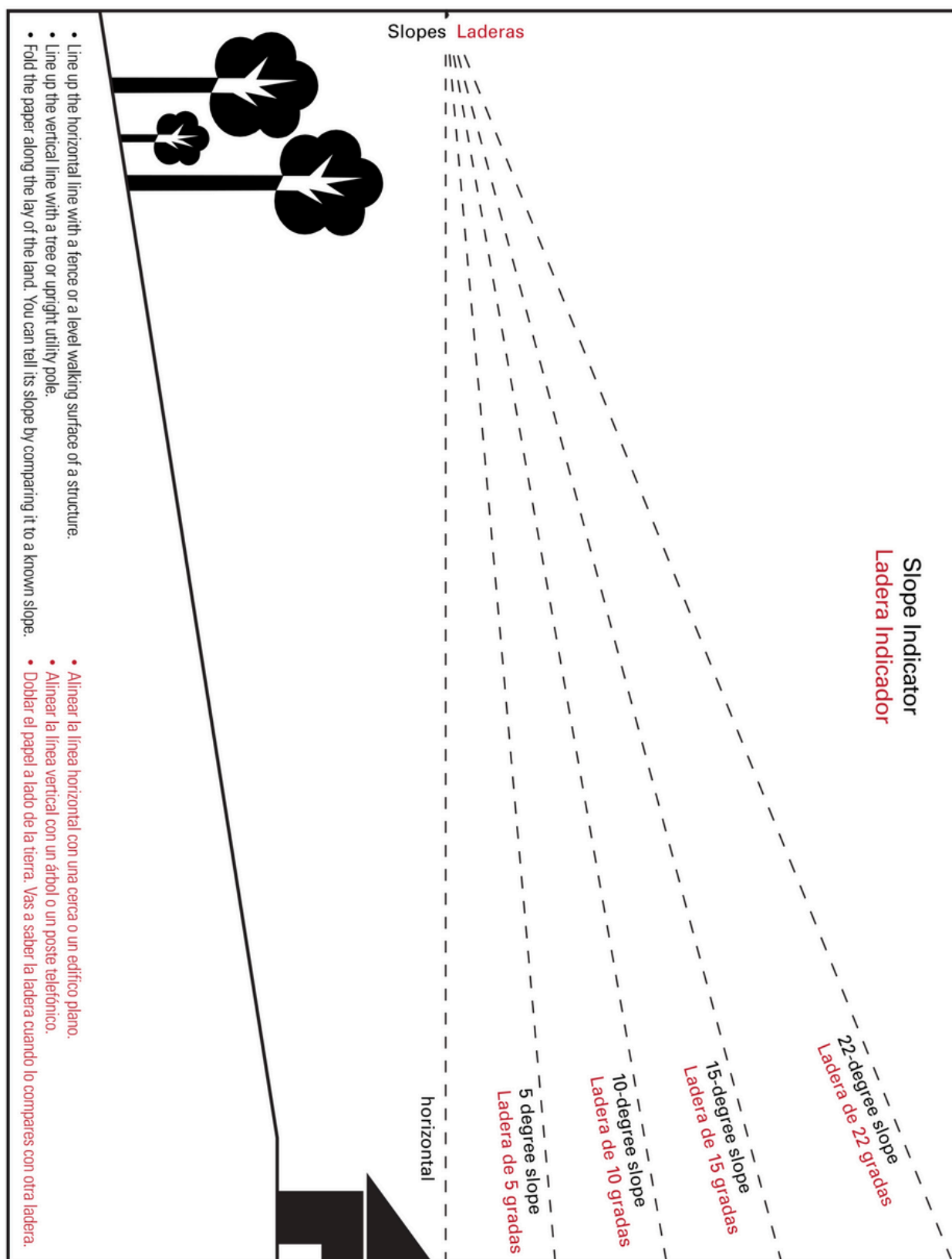

Assembly & Set-Up

This manual applies to multiple configuration of Side Discharge Series mowers, please find instruction suits

your model.

Content of Carton

- | | | |
|---------------------------------|-----------------------------|-------------------------|
| (1)Lawn Mower | (2)Grass Catcher | (3)Hardware Pack |
| (4)Lawn Mower Operator's Manual | (5)Engine Operator's Manual | (6)Side Discharge Chute |
| (7)Mulch Plug | (8)Cup Holder | |

Assembly

Handle

Remove any packing material which may be between upper and lower handles.

- a. Use two bolts and two nuts on each side to tighten handle. Make certain the lower handle is seated securely into the handle mounting brackets. Do not crimp cable while lifting the handle up.
- b. Spin the outside handle-adjustment part to make the handle height suitable. Make sure two gears are clutched completely. Tighten triangle knobs on both sides.

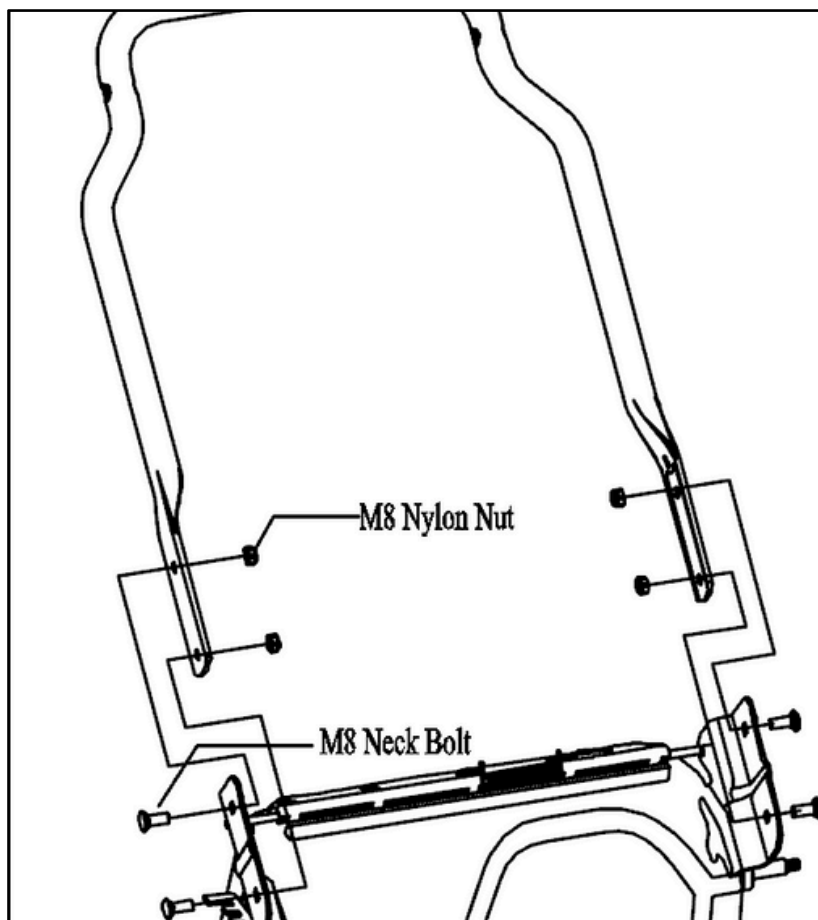

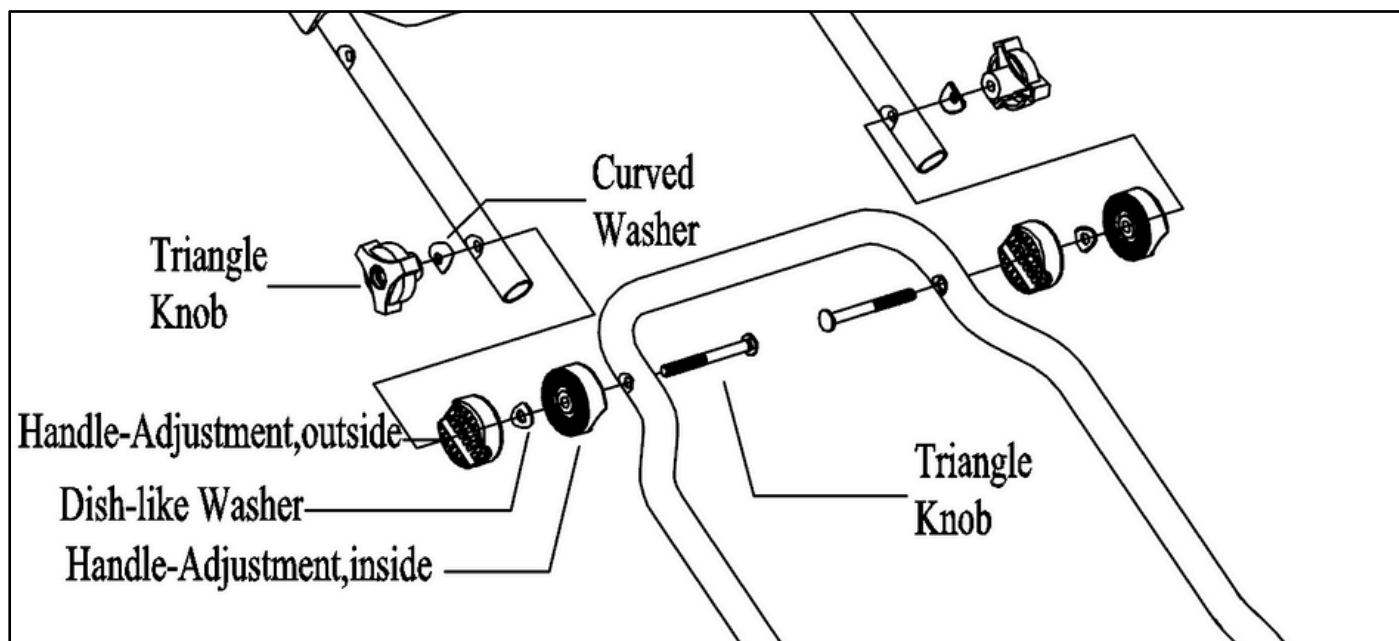

Cup Holder

Pick up 4 washers, 4 bolts and a cup holder. Use screwdriver to install the cup holder onto upper handle.

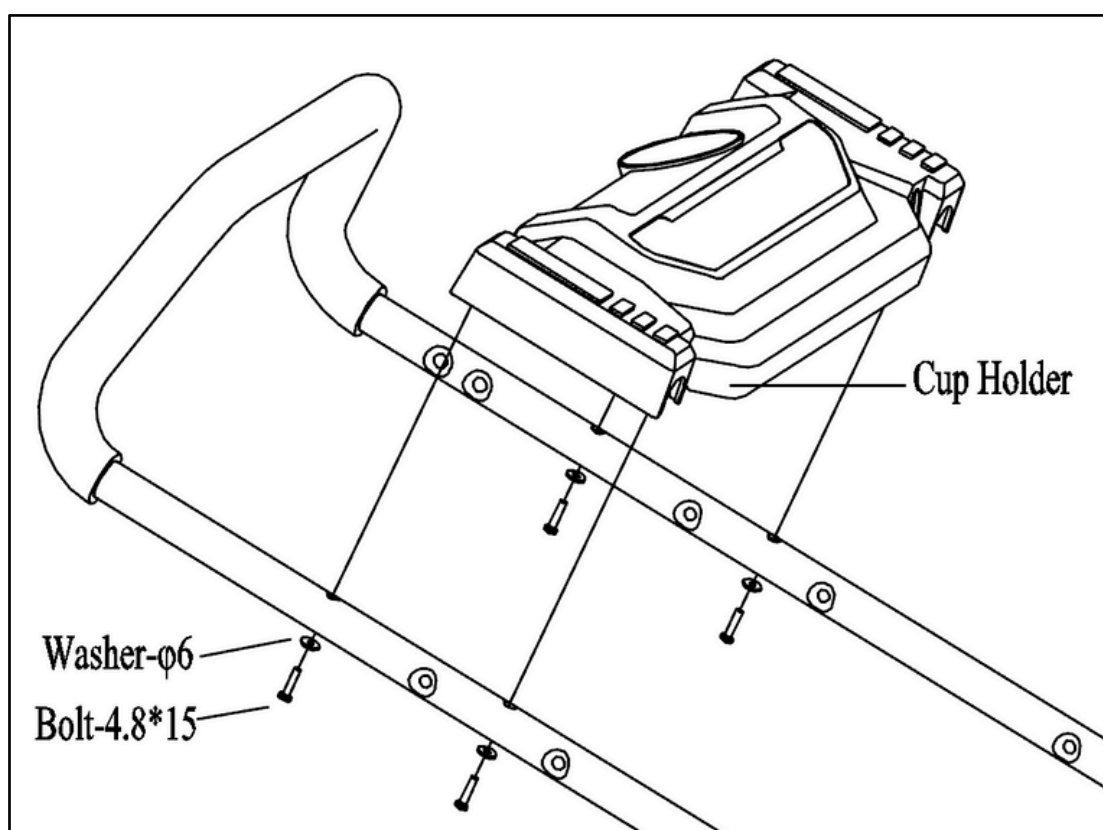

Control Lever

Clutch Lever

Clutch Lever is used to control Self Propelled function. If there's two sets of installation holes on the upper handle, use the upper one to install Clutch Lever.

- Hang end of Clutch Cable on the side hole of clutch lever. Make sure the cable is hooked into the hole reliably.
- Insert the side mounting rods into the upper handle holes in both sides.
- Engage the Lever and pull backward the machine to check if the tightness of clutch cable is suitable. If rear wheel can rotate backward when engaging the lever, then tighten the cable. Adjust the upper and lower nuts until the rear wheel can't rotate in this situation. Be noticed that Clutch Cable must have slack when light finger pressure applied on otherwise you need to loose a little bit.

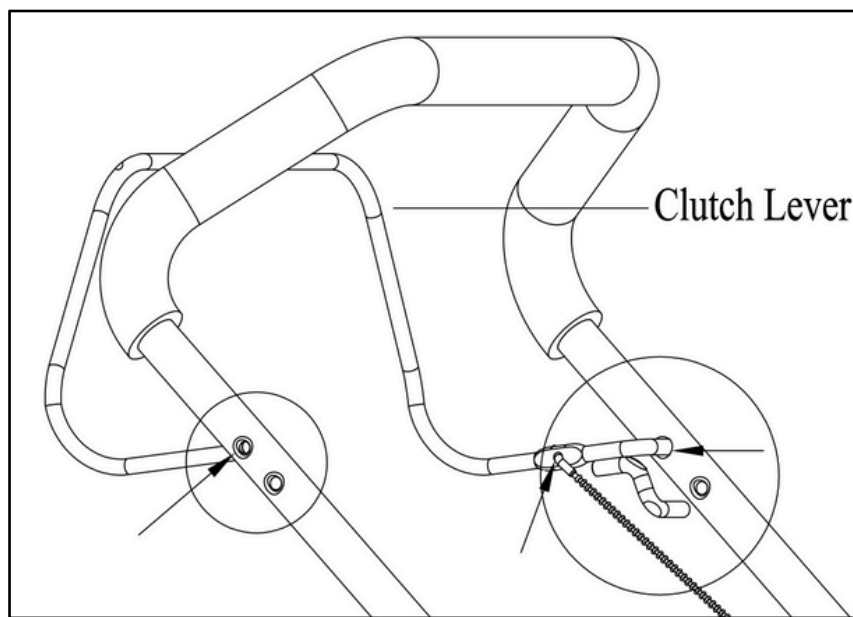

Braking Lever

Braking Lever is used to stop the engine. If there's two sets of installation holes on the upper handle, use the lower one to install Braking Lever.

- Hang end of Braking Cable on the side hole of Braking Lever. Make sure the cable is hooked into the hole reliably.
- Insert two ends of side mounting rods into the lower handle holes in both sides.
- Be noticed that Braking Cable must have slack when light finger pressure applied on otherwise you need to loose a little bit. Braking Cable could be extended after long-time use, you can tight it with two adjustment nuts.

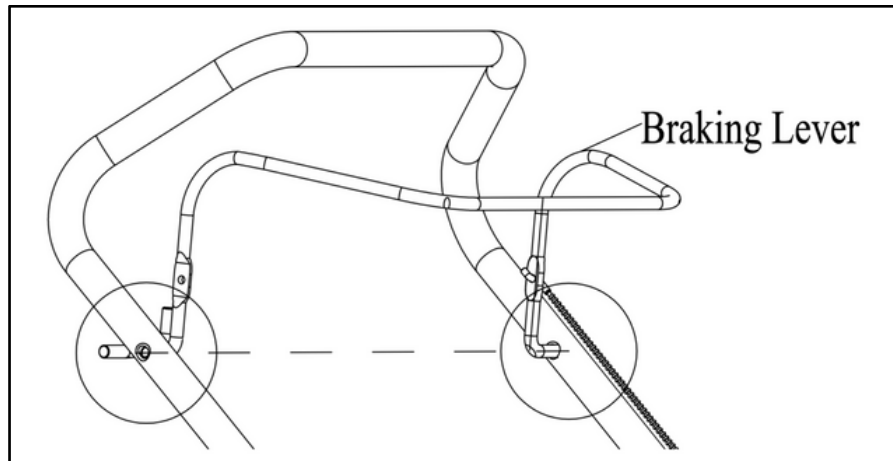

Side Discharge Chute

Open Side Discharge Plate and install the Side Discharge Chute onto the axle.

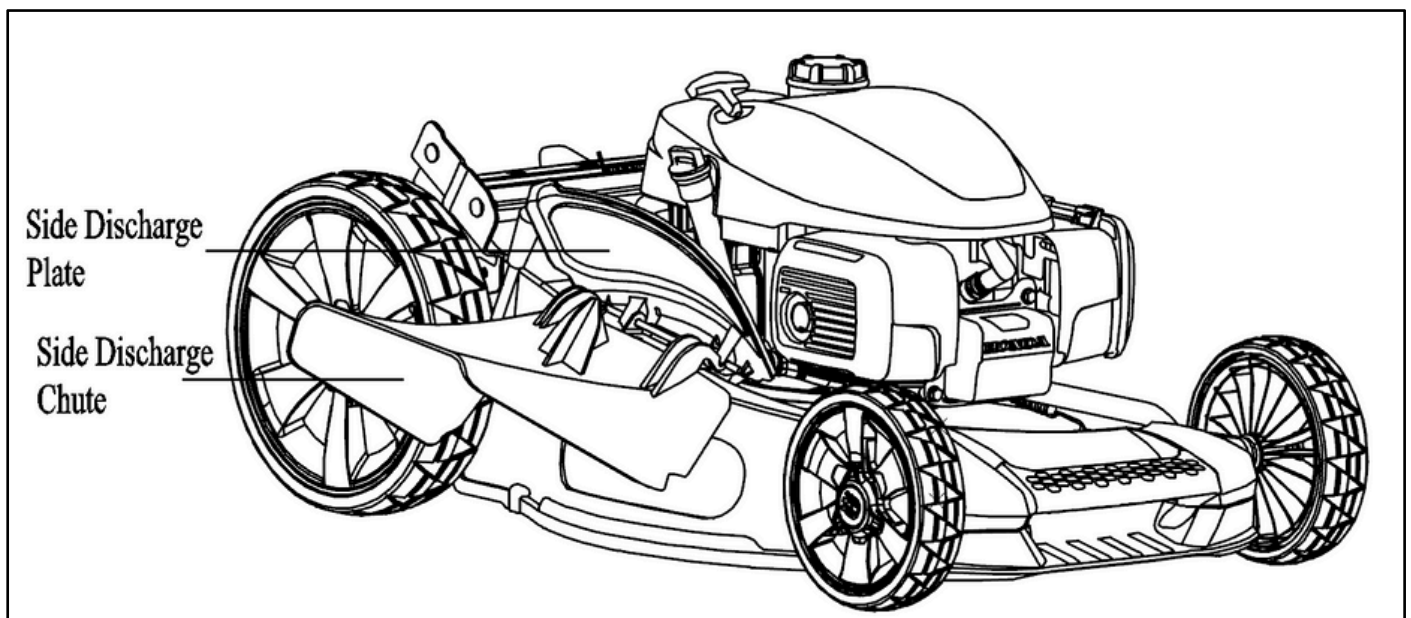

Grass bag

To mount the grass bag, lift the rear flap and mount the grass bag on the rear axle of the flap.

Set-Up

Gas and Oil Fill-Up

WARNING: Use extreme care when handling gasoline. Gasoline is extremely flammable and the vapors are explosive. Never fuel the machine indoors or while the engine is hot or running. Extinguish cigarettes, cigars, pipes and any other sources of ignition.

Refer to the Engine Operator's Manual for additional engine information.

1. There is no lube added after manufactured for shipment reason. Please add oil for the first-time start.
2. Service the engine with gasoline as instructed in the Engine Operator's Manual.

Operation

Starting Engine

WARNING: Be sure no one other than the operator is standing near the lawn mower while starting engine or operating mower. Never run engine indoors or in enclosed, poorly ventilated areas. Engine exhaust contains carbon monoxide, an odorless and deadly gas. Keep hands, feet, hair and loose clothing away from any moving parts on engine and lawn mower.

Refer to Engine Operator's Manual for help with the engine. 1. If the engine has a primer, push the primer three times. Do not prime to restart a warm engine. **NOTE:** If you push the primer too many times, excessive fuel will flood the engine and it will be difficult to start. 2. Push Throttle Control Lever forward to gain the best starting performance. 3. Standing behind the mower, engage the Brake Lever against upper handle. 4. Holding these two handles together firmly, grasp recoil starter handle and pull rope out with a rapid, continuous, full arm stroke. Keeping a firm grip on the starter handle, let the rope rewind slowly. Repeat until engine cranks. Let the rope rewind each time slowly. 5. When the machine is started, pull backward the Throttle Control Lever a little bit to leave "Close Choke" gear.

Stopping Engine

Release Braking Lever to stop the engine and blade. If the engine will not stop, hold a screwdriver against the spark plug and against the engine cooling fins. The spark will go to ground and the engine will stop.

WARNING: Before you try to start the engine, operate the Braking Lever several times to make sure the lever can move easily. Wait for the blade to stop completely before performing any work on the mower or to remove the mulching baffle.

Engine Speed Control (For Throttle Control Model)

With Throttle Control lever, the user can adjust the speed of engine. The "Rabbit" symbol represents highest speed, and the "Turtle" symbol represents lowest speed. Some engine may also accept open/close choke. For easy start, please always shift the gear to the "Rabbit" gear or "Close Choke" gear. When the machine is started, pull backward the Throttle Control Lever a little bit to switch to Fast.



Self Propelled Function

To self-propel your lawnmower, please follow the steps:

1. Start the engine as Starting Engine chapter described above.
2. Engage the Clutch Lever to the main handle. The lawnmower will start to move with the engine running and blade rotating. It is easier to manually push the machine a couple of steps and then engage the self propelled motion to ensure the grass is not damaged and the machine does not take off, away from the user suddenly.
3. To stop the lawnmower moving, just simply release the Clutch Lever.
4. If you want to adjust the moving speed, push Gearbox Control Lever forward or backward to change the speed.

Rear Discharge Function

If you have chosen a Rear Flap with Block, you can switch the machine into Rear Discharge Mode. Open the Rear Flap and pull the Block to limit the position of the Rear Flap.

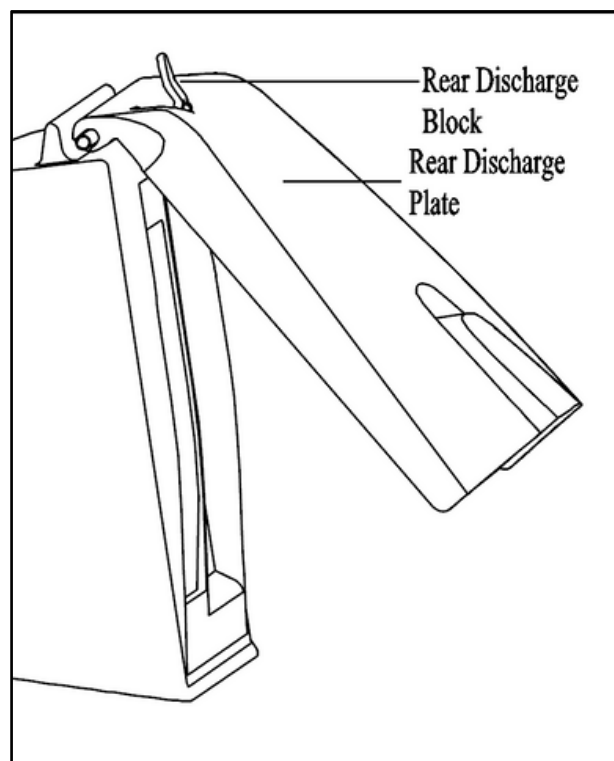

Using Your Mower

Be sure lawn is clear of stones, sticks, wire or other objects which could damage lawn mower or engine. Such objects could be accidentally thrown by the mower in any direction and cause serious personal injury to the operator and others.

WARNING: The operation of any lawn mower can result in foreign objects being thrown into the eyes, which can damage your eyes severely. Always wear safety glasses while operating the mower, or while performing any adjustments or repairs on it.

WARNING: If you strike a foreign object, stop the engine. Remove wire from the spark plug, thoroughly inspect mower for any damage, and repair damage before restarting and operating. Extensive vibration of mower during operation is an indication of damage. The unit should be promptly inspected and repaired.

Maintenance

General Recommendations

1. Always observe safety rules when performing any maintenance.
2. The warranty on this lawn mower does not cover items that have been subjected to operator abuse or negligence. To receive full value from warranty, operator must maintain the lawn mower as instructed here.
3. Changing of engine-governed speed will void engine warranty.
4. All adjustments should be checked at least once each season.
5. Periodically check all fasteners and make sure these are tight.

Engine Tipping

When you service the engine, inspect the blade or clean the underside of the mower, make sure to always tip the engine with the spark plug up. Tipping the engine with the spark plug down will cause hard starting, engine smoking, spark plug fouling or oil saturation to the air filter.

Lubrication

For maximum performance, lubricate the wheels and all pivot points with oil periodically.

1. Lubricate pivot points on the control lever at least once a season with light oil. This control must operate freely in both directions
2. Lubricate the wheels at least once a season with light oil (or motor oil). If wheels are removed for any reason, lubricate surface of the axle bolt and inner surface of the wheel with light oil.
3. Follow the Engine Operator's Manual for lubrication schedule and instruction for engine lubrication.

Clean the Mower

After you mow, grass and other debris can keep the mower from working correctly. Clean underside of the mower deck after each use to prevent build-up of grass clippings or other debris. Follow steps below for proper cleaning.

1. Allow the engine to run until it is out of fuel. Do not attempt to pour fuel from the engine. Disconnect spark plug wire. Refer to Engine Operator's Manual.
2. Tip mower so that it rests on the housing. Keep the side with the air cleaner facing up. Hold mower firmly.
3. Scrape and clean the underside of the chassis with a suitable tool.
4. Put the mower back on its wheels on the ground.

Engine Care

A list of key engine maintenance jobs required for good performance by the mower are listed below. Follow the Engine Operator's Manual for a detailed list and instructions.

1. Maintain oil level as instructed in Engine Operator's Manual.
2. Service air cleaner every 25 hours under normal conditions. Clean every few hours under extremely dusty conditions.
3. Poor engine performance and flooding usually indicates that the air cleaner should be serviced. To service the air cleaner, refer to the Engine Operator's Manual.
4. Clean spark plug and reset the gap once a season. Spark plug replacement is recommended at the start of each mowing season. Check Engine Operator's Manual for correct plug type and gap specifications.
5. Clean engine regularly with a cloth or brush. Keep the top of the engine clean to permit proper air circulation. Remove all grass, dirt, and combustible debris from muffler area.
6. Engines stored between 30 and 90 days need to be treated with a gasoline stabilizer to prevent deterioration and gum from forming in fuel system or on essential carburetor parts.

Cable Maintenance

After a period time of usage, the cable could be extended and influence the performance. Our cable can be at optimized status by adjust the nuts of cables. Braking Cable: When release the Braking Lever, the upper segment of Braking cable should have a little bit tension. If not, adjust the nuts up if it's too tight or adjust the nuts down if it's too loose. Clutch Cable: Engage the Clutch Lever and pull the machine backward. If it can't be pulled, then the machine is OK. Otherwise, the user should spin the nuts down. Release the Clutch Lever and pull the machine backward. If it can be pulled, then the machine is OK. Otherwise, the user should spin the nuts up.

Blade Care

WARNING: When removing the cutting blade for sharpening or replacement, protect your hands with a pair of heavy gloves or use a heavy rag to hold the blade. Periodically inspect the blade adapter for cracks, especially if you strike a foreign object. Replace when necessary. Follow the steps below for blade service. 1. Allow the engine to run until it is out of fuel. Do not attempt to pour fuel from the engine. Disconnect spark plug wire. Refer to Engine Operator's Manual. 2. Turn mower on its side making sure that the air filter facing up. 3. Remove the bolt that holds the blade or round blade disc assembly. 4. Remove blade or round blade disc assembly from the crankshaft. 5. Replace with a factory manufactured blade or sharpen the original one. When sharpening the blade, follow the original angle of grind. Grind each cutting edge equally to keep the blade balanced. Balance the blade on a round shaft screwdriver to check. Remove metal from the heavy side until it balances evenly. **WARNING:** An unbalanced blade will cause excessive vibration when rotating at high speeds. It may cause damage to mower and could break causing personal injury. 6. Place blade or round blade disc assembly on the crankshaft, installation hole is homocentric. 7. Place washer(s) and put through hex bolt through hole of blade or round blade disc assembly. 8. Tighten hex bolt to torque: 50Nm(min), 60Nm (max). To ensure safe operation of your mower,

periodically check the blade bolt for correct torque.

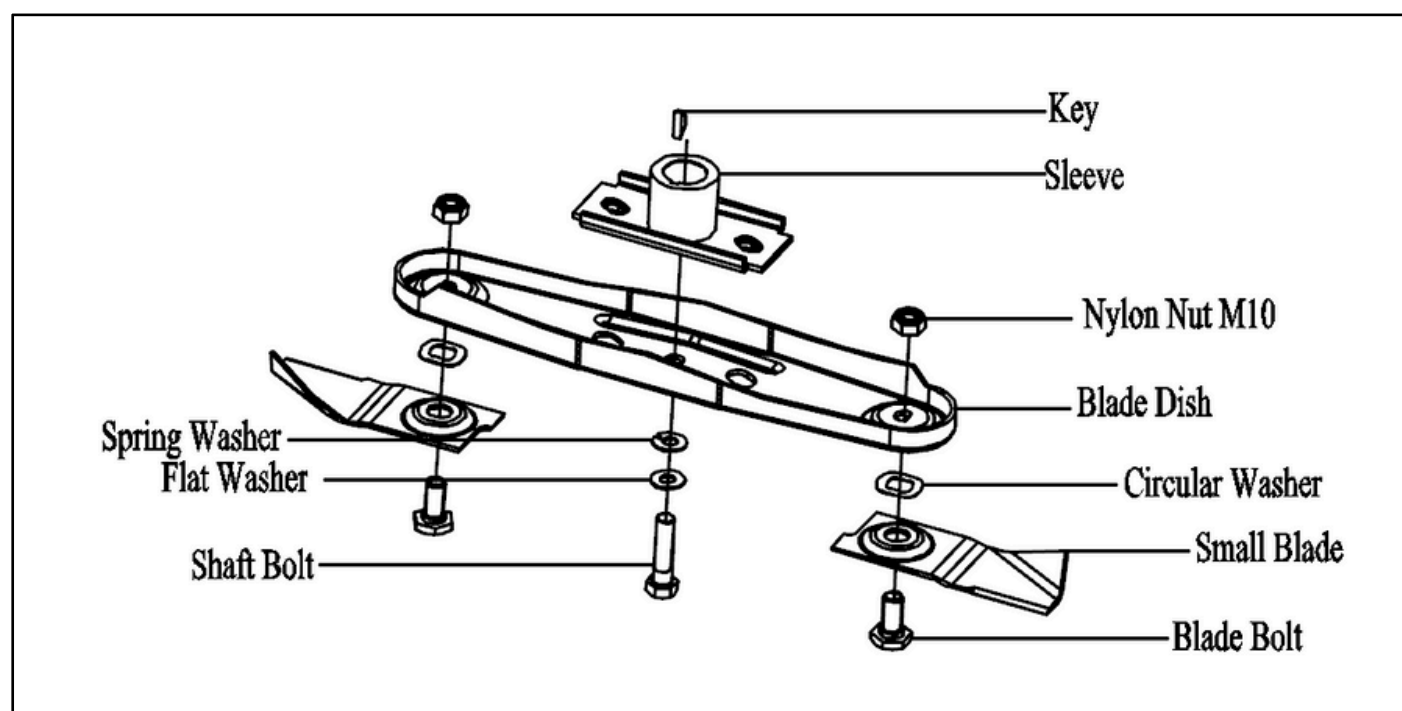
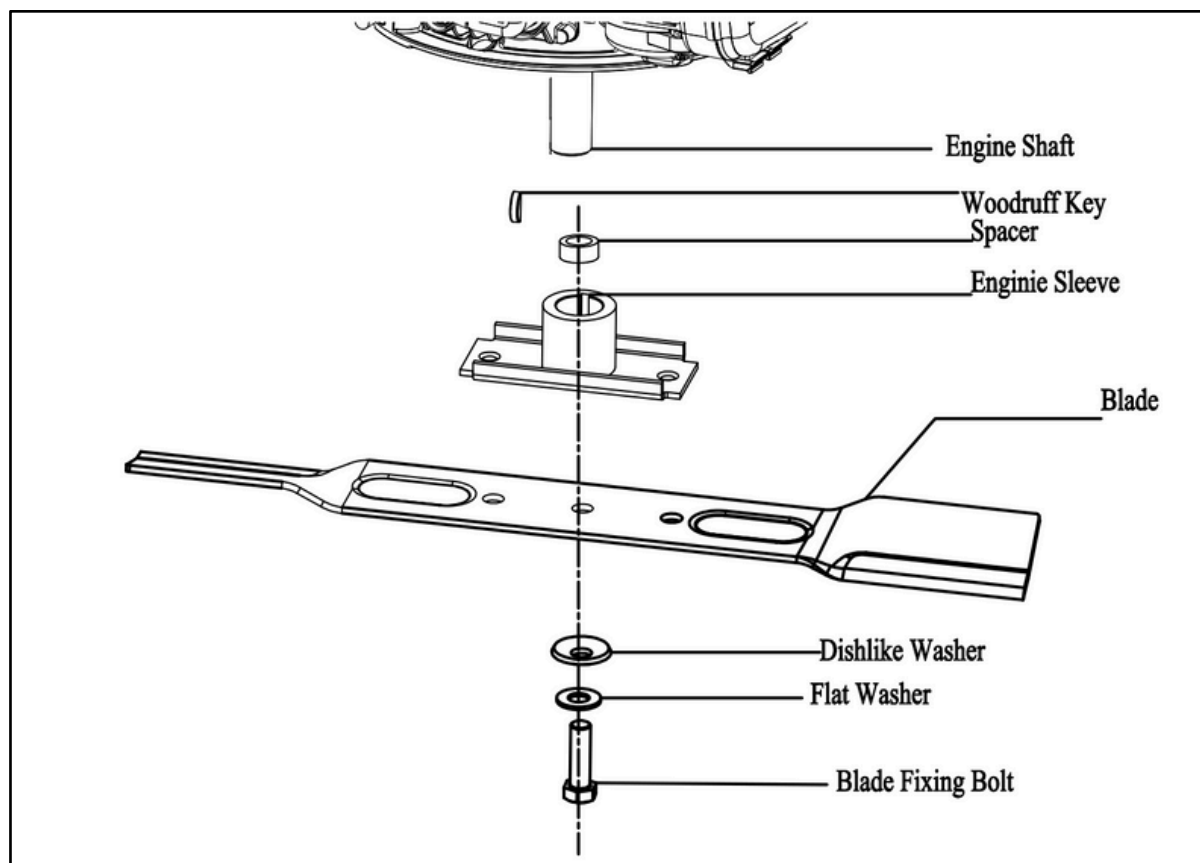

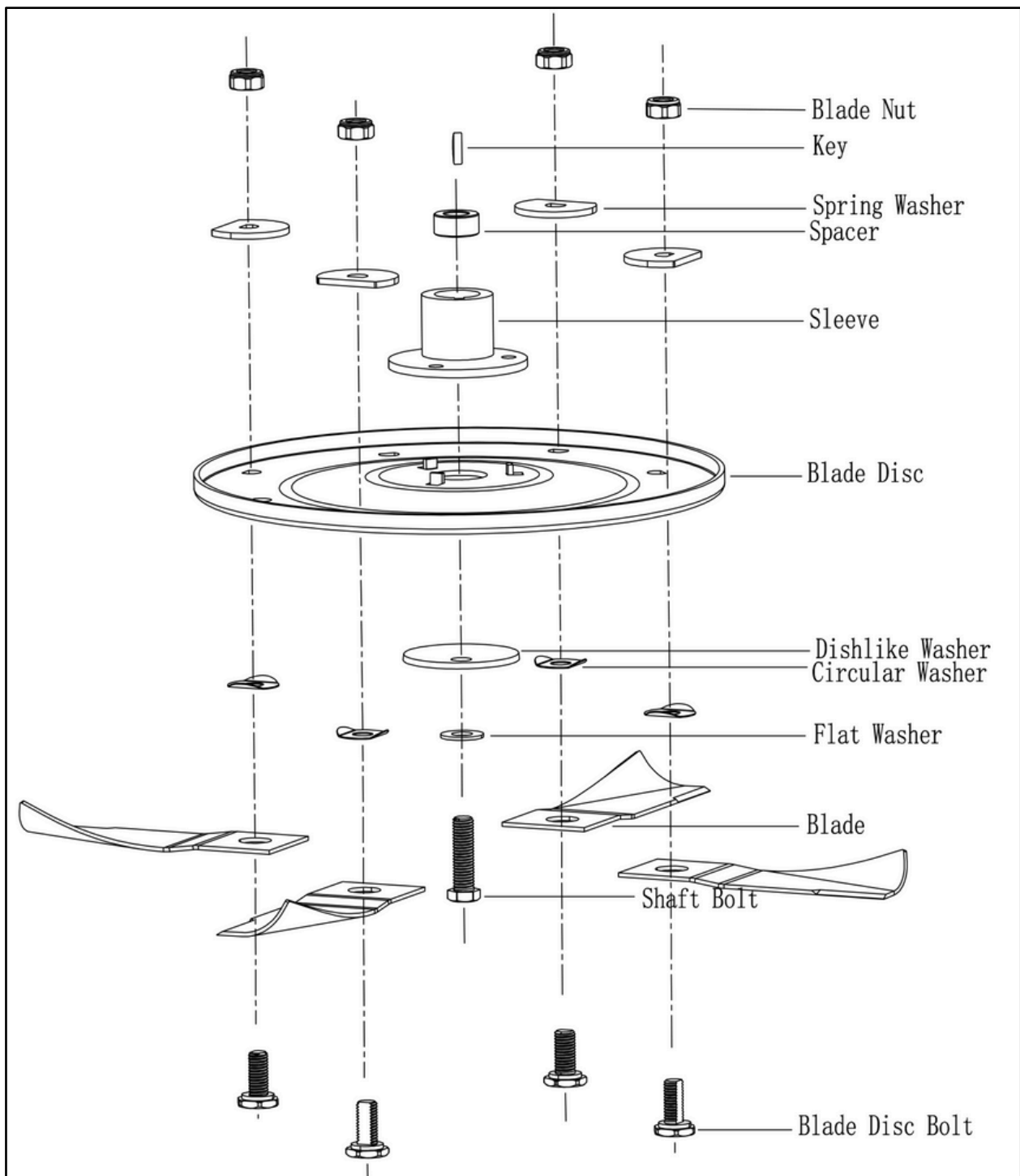

Off-Season Storage

The following steps should be taken to prepare your lawn mower for storage.

1. Clean and lubricate mower thoroughly as described in the Lubrication section.
2. Coat mower's cutting blade with grease to prevent rusting.
3. Refer to Engine Operator's Manual for correct engine storage instructions.
4. Store mower in a dry, clean area. Do not store next to corrosive materials, such as fertilizer.

When storing any type of power equipment in a poorly ventilated or metal storage shed, care should be

taken to rust-proof the equipment. Using a light oil or silicone, coat the equipment, especially cables and all moving parts of your lawn mower before storage.

Troubleshooting

Problem	Cause	Remedy
Engine fails to start	<ol style="list-style-type: none"> 1. Blade control disengaged. 2. Spark plug boot disconnected. 3. Fuel tank empty or stale fuel. 4. Engine not primed (if equipped with primer). 5. Faulty spark plug. 6. Blocked fuel line. 7. Engine flooded. 	<ol style="list-style-type: none"> 1. Engage blade control. 2. Connect wire to spark boot. 3. Fill tank with clean, fresh gasoline. 4. Prime engine as instructed in the Operation section. 5. Clean, adjust gap, or replace. 6. Clean fuel line. 7. Wait a few minutes to restart, but do not prime.
Engine runs erratic	<ol style="list-style-type: none"> 1. Spark plug boot loose. 2. Blocked fuel line or stale fuel. 3. Vent in gas cap plugged. 4. Water or dirt in fuel system. 5. Dirty air cleaner. 	<ol style="list-style-type: none"> 1. Connect and tighten spark plug boot. 2. Clean fuel line; fill tank with clean, fresh gasoline. 3. Clear vent. 4. Drain fuel tank. Refill with fresh fuel. 5. Refer to Engine Operator's Manual.
Engine overheats	<ol style="list-style-type: none"> 1. Engine oil level low. 2. Air flow restricted. 	<ol style="list-style-type: none"> 1. Fill crankcase with proper oil. 2. Clean area around and on top of engine.
Occasional skips (hesitates) at high speed	<ol style="list-style-type: none"> 1. Spark plug gap too close. 	<ol style="list-style-type: none"> 1. Adjust gap. Refer to Engine Operator's Manual.
Idles poorly	<ol style="list-style-type: none"> 1. Spark plug fouled, faulty, or gap too wide. 2. Dirty air cleaner. 	<ol style="list-style-type: none"> 1. Reset gap or replace spark plug. 2. Refer to Engine Operator's Manual.
Excessive vibration	<ol style="list-style-type: none"> 1. Cutting blade loose or unbalanced. 2. Bent cutting blade. 	<ol style="list-style-type: none"> 1. Tighten blade and adapter. Balance blade. 2. See an authorized service dealer.
Uneven cut	<ol style="list-style-type: none"> 1. Wheels not positioned correctly. 2. Dull blade. 	<ol style="list-style-type: none"> 1. Place all four wheels in same height position(FOR SK MODEL). 2. Sharpen or replace blade.

Maintenance schedule

<div> <div>FREQUENCY</div> <div>ACTION</div> </div>		Before each use	After each use	Each 10 hours	Each 25 hours or once per season	Before storage	Information
MACHINE	Check elements	•				•	
	Clean box	•	•			•	
	Clean machine		•			•	
	Check / change belt				• Check		Replace if necessary
	Clean the air vents	•	•			•	
	Check/replace guide wheels				• Check		Replace if necessary
	Check/clean/lubricate drive system	• Clean	• Clean		• Lubricate	• Clean and lubricate	Clean shaft
ENGINE	Check oil	•				•	
	Check fuel					•	
	Change oil				•		More often if condtions are hard
	Clean air filter			•			More often if condtions are hard
	Check / replace spark plug				•		
	Change air filter				•		More often if dirty
	Check muffler				•		More often if condtions are hard