



HAHN A SYN s.r.o.
Lelkova 186/4
747 21 Kravaře
CZECH REPUBLIC
info@hahn-profi.cz

Hahn & Sohn GmbH
Janahof 53
93413 Cham
Deutschland
hahn@hahn-sohn.de



Lawn mower

MODEL NO.: KS51P

SERIAL NO.:

Model and serial numbers are listed on the manufacturer's nameplate.

Write them down and keep them in a safe place.

: Read and follow all safety rules and instructions before using this device.

CAUTION



Thank you for choosing our Gasoline Lawnmower.

To ensure that you get the best results from your Gasoline Lawnmower please read all of these safety and operating instructions carefully before using this product.

TABLE OF CONTENTS

1. <i>Safety messages</i>	3
2. <i>Assembly</i>	5
3. <i>Before operation</i>	8
4. <i>Operation</i>	10
5. <i>Maintenance</i>	11
6. <i>Storage</i>	17

1. Safety messages

Your safety and the safety of others are very important. We have provided important safety messages in this manual and on the mower. This information alerts you to potential hazards that could hurt you or others. Please read these messages carefully.

Of course, it is not practical or possible to warn you about all the hazards associated with operating or maintaining a lawn mower. You must use your own good judgment.

You will find important safety information in a variety of forms:

Safety Labels  on the lawn mower.

Instructions  how to use this mower correctly and safely.



Important: Read the instruction manual before using the machine.



Danger of thrown objects.

Keep other people at a safe distance while working



Warning: Remove the spark plug cable from the spark plug and read instructions before carrying out any repair or maintenance.



Danger of cutting yourself.

Blades in movement. Do not put hands or feet near or under the opening of the cutting plate.

Safety Messages – preceded by a safety alert  symbol and one of three signal words: DANGER, WARNING, or CAUTION.



You will be killed or seriously hurt if you don't follow instructions



You will be killed or seriously hurt if you don't follow instructions.



You can be hurt if you don't follow instructions.

Each message tells you what the hazard is, what can happen, and what you can do to avoid or reduce injury.

General Conditions Of Use.

- ☒ This machine is to be used exclusively for cutting natural grass. Never use the mower for other purposes. Any other utilization can involve danger for your safety and can involve damage to the mower.
- ☒ Persons under 16 years of age and persons who are not familiar with the user instructions must not use the mower.
- ☒ The user is responsible of the safety of other people in the working area. Keep children and domestic animals at a safe distance while the mower is in use.
- ☒ Before mowing, remove all foreign object from the lawn which may be thrown by the machine, stay alert for any foreign objects which may have been missed.

Using Instructions

- ☒ Check that all nuts, bolts and screws are well tightened.
- ☒ Before mowing place the grass catcher in its position.
- ☒ Before mowing make sure that the blade and the blade fixing screw are securely fastened. When cutting edges require resharpening, this must be done evenly on both sides so as to prevent any imbalance. If the blade is damaged, it must be replaced.
- ☒ When mowing always wear a long trousers and strong footwear.
- ☒ Do not run the engine in an enclosed and/or poorly ventilated area, where gas of the engine contains carbon monoxide, which are dangerous for your health.
- ☒ Work only when there is sufficient light.
- ☒ Do not use the lawnmower when it is raining or when the grass is wet.
- ☒ Particular precautions must be taken while mowing on slopes or downing stretches. Mow across the face of slopes, never down or up.
- ☒ Turn off the engine if you must leave the lawnmower unattended, displace the lawnmower or incline it.
- ☒ Never lift the rear of the mower while starting the engine and never place your hands and feet underneath the deck or into the rear discharge chute while the engine is running.
- ☒ Never change in any way the rated speed of the engine.
- ☒ On the self-propelled mowers, disconnect the self-propelled system before starting the engine.
- ☒ Never lift or carry the mower while the engine is running.
- ☒ Stop the engine and remove the spark plug cover in these cases:
 - Before any operation under the deck or the grass rear discharge chute.
 - Before any maintenance, repairing or checking operations.
 - Before carrying, lifting or removing the mower.
 - If you leave the mower unattended or changing the cutting height.
 - To remove and emptying the grass catcher.
 - After hitting a foreign object, stop the engine and check thoroughly the mower in order to see if it is damaged. Bring the mower in a agreed service station to do  **WARNING** necessary.

After you stopped the engine the blade is still in motion during a few seconds

- If the mower vibrates in an abnormal way, find the reasons why, and take your mower to

an agreed service station.

- Check regularly that bolts, nuts and screw are regularly tightening for a safe use of the mower.

-

☒ GASOLINE IS HIGHLY INFLAMMABLE

- Keep gasoline in a jerry can specially made for this purpose.
- Fill up the tank with a funnel, do the operation outside. Do not smoke. Do not use mobile phone.
- Fill up with gasoline and oil before starting the engine. Never open the cap of the fuel tank to add gasoline while the engine is running or still hot.
- Do not start the engine if there is some gasoline spread around, take the mower away from the one where gasoline have been split and avoid any contact from a hot source as long as the split gasoline is completely evaporated.
- Tighten the fuel tank cap and close tightly the jerry can cap.

2. Assembly

Unpacking

Remove lawn mower from carton and check thoroughly for additional loose parts.

Handle Setup

Step 1: Put the lower handle insert two bolt on the deck.

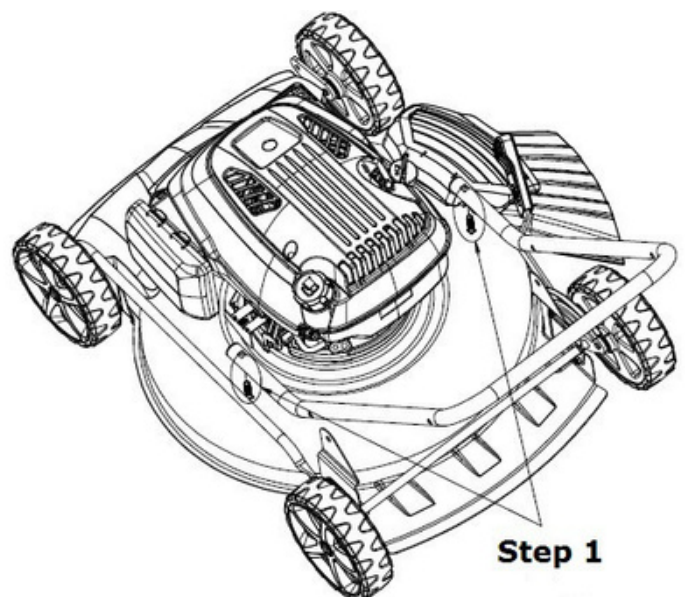

Step 2: Put two bolts through two holes.

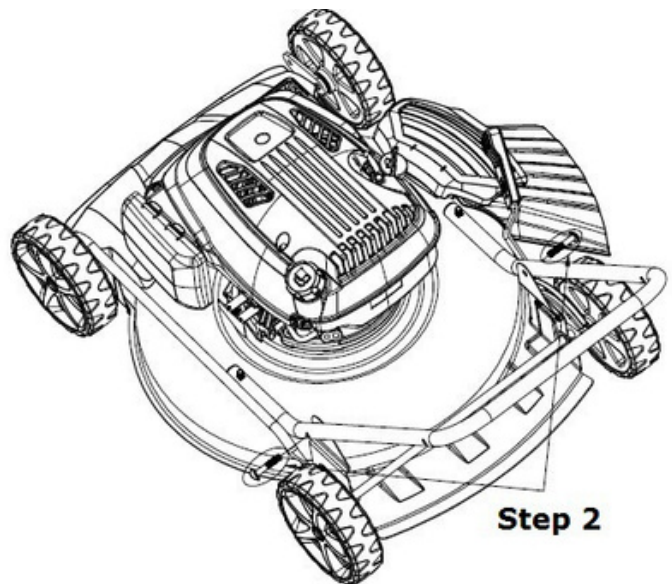

Step 3 Tighten two nuts and two knobs.

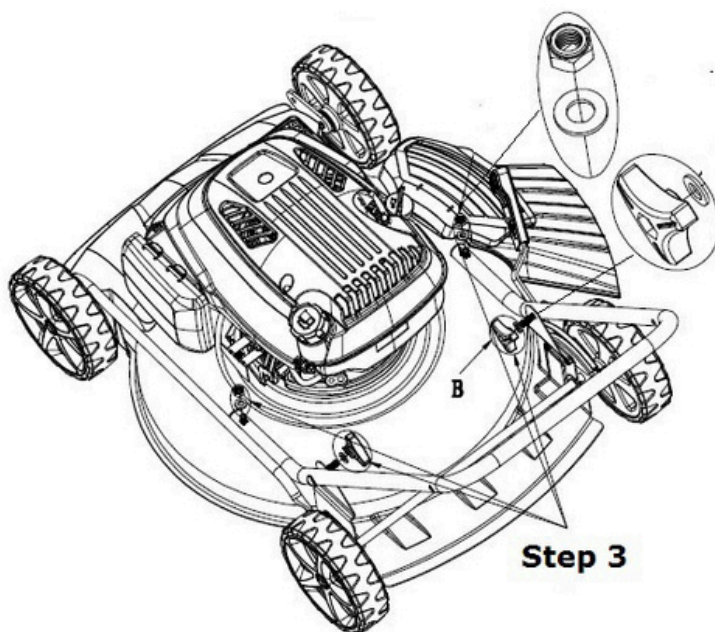

Step 4: Screw the upper handles parts with the two bolts and knobs. Put the recoil starter on the right of the handle and fix the cable with the plastic collar.

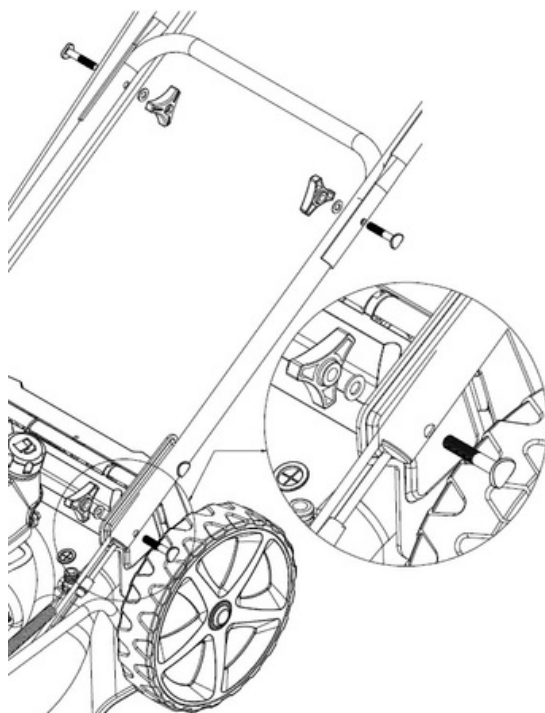

Inner Rear Wheel Cover Assembly

Mounting the inner wheel cover as shown in the illustration.

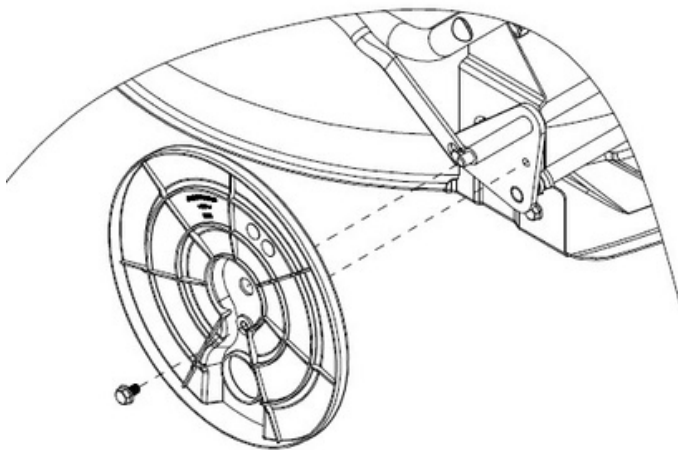

Wheels Assembly

Put four wheels into corresponding wheel axle and tighten nuts, then fasten wheel covers on wheels.

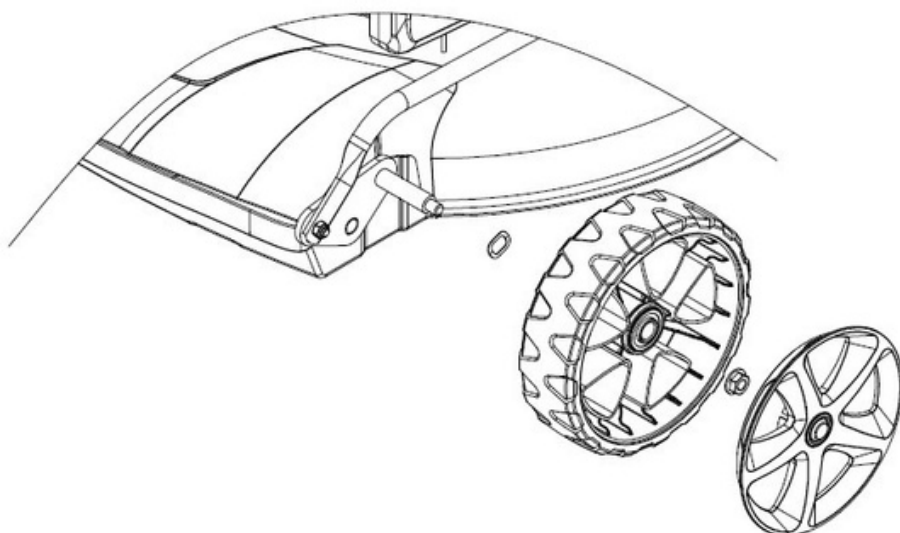

Side Discharge Cover Assembly

Lift the side discharge guard, install the side discharge cover.

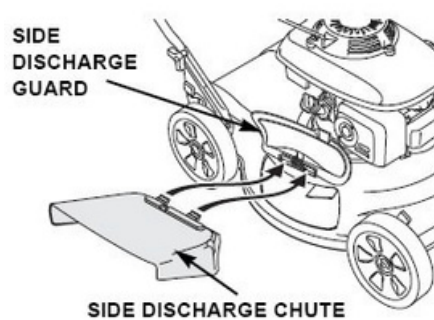

Only Mulching: please remove the side discharge cover.

3. Before Operation

Engine Oil

The mower is shipped without oil in the engine.

All engines are run at the factory prior to packaging. Most of the oil is removed prior to shipment; however, some oil remains in the engine. The amount of oil left in the engine varies.

Add enough oil to bring the oil level between the upper and lower limit marks on the dipstick as shown. Do not overfill engine with oil.

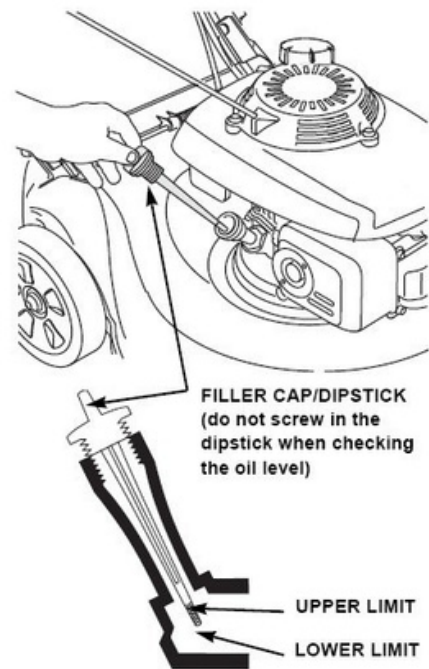

FUEL

NOTICE Engine delivered without gasoline, refuel 1.0 liter of before starting the engine.

- ☒ Remove the filler cap Add fuel to the bottom of the
- ☒ fuel level limit in the neck of the fuel tank. Do not overfill. Wipe up spilled fuel before starting the engine. Tighten the
- ☒ fuel tank cap

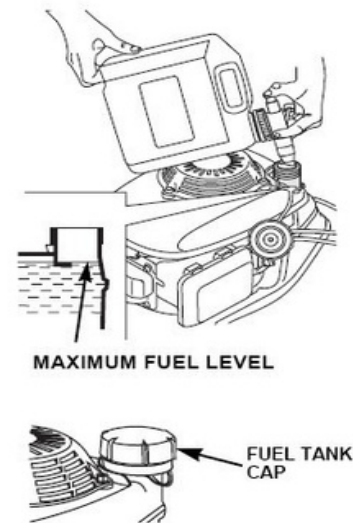

⚠ WARNING Gasoline is extremely flammable, and gasoline vapor can explode, causing serious injury or death. Use extreme caution when handling gasoline. Keep out of reach of children.

Refuel in a well-ventilated area with the engine stopped. Do not smoke or allow flames or sparks in the area where the engine is refueled or where gasoline is stored. Avoid repeated or prolonged contact with skin or breathing of vapor.

After refueling, tighten the fuel tank cap securely. If any fuel was spilled, make sure the area is dry before starting the engine.

Cutting Height Adjustment

Check the cutting height settings, and make any necessary adjustments.

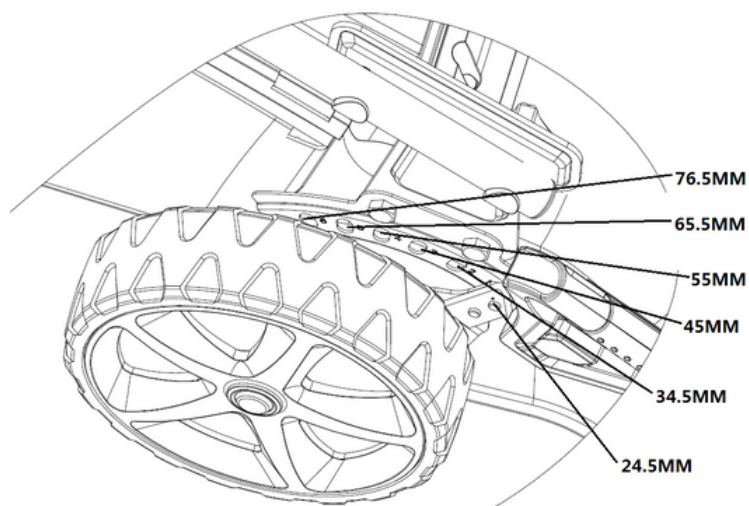

The blade can cause serious injury. Stop the engine before adjusting cutting height.

4. Operation

Starting The Engine

☒ Primer (Only for G46P-B, G46SHL-B)

In cold condition, it's necessary to push the primer button on the air filter before pulling the starter handle.

Primer only for cool engine use

Temperature	Push time
<0°C	3~4
0°C~10°C	2~3
10°C~20°C	1~2
>20°C	1

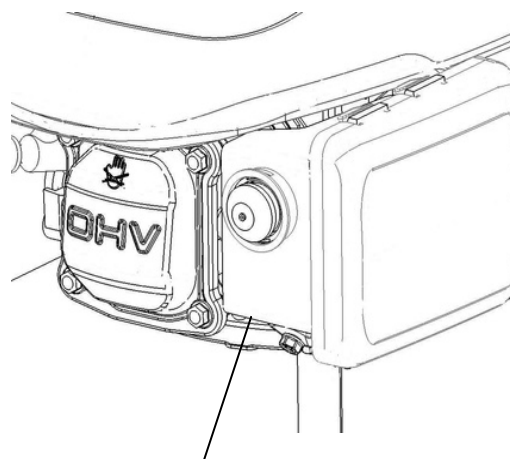

PRIMER
BUTTON

We also should put more fuel to mix air for easy start. When you push the primer button, it will

pump the fuel direct from carburetor to burning house.

NOTICE In cold condition it may be necessary to repeat priming steps.

- ☒ Pull back on the brake lever and hold it against the handle.

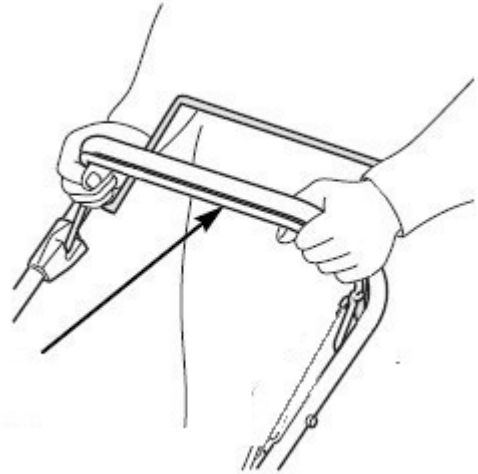

BRAKE LEVER

- ☒ With the starter handle in its support, take the starter handle with your right hand and pull slowly as far as to have a resistance, then pull

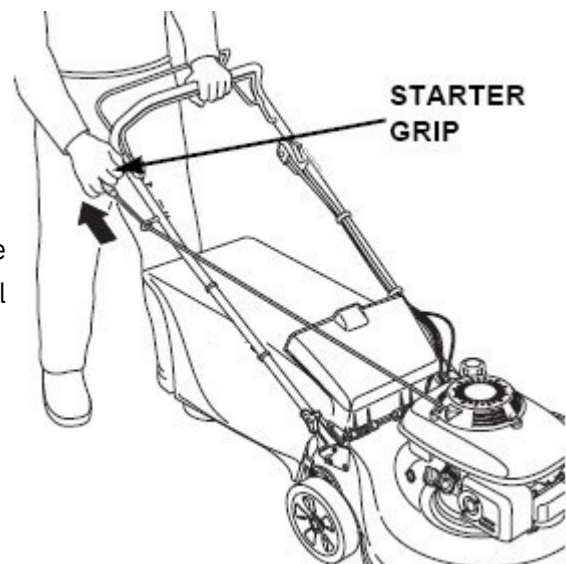

energetically on the starter handle with starter rope through the support. (If the cold start is not sufficient enough, repeat this operation 2 or 3 times)

Stop Engine

- ☒ Release the brake lever.

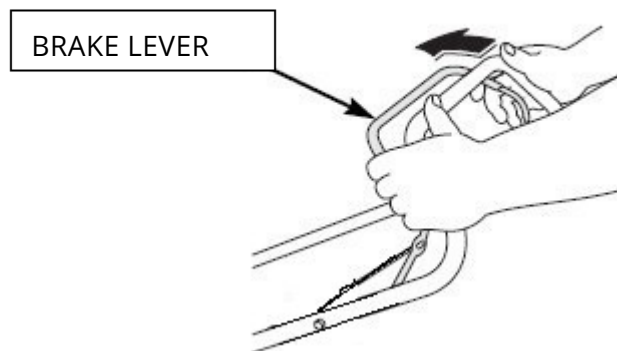

⚠ WARNING

The blade will continue to rotate for a few seconds after the engine has stopped. Disconnect the spark plug cap if the lawnmower is to be left

unattended.

5. Maintenance

IMPORTANT Regular, careful maintenance is essential for keeping the safety level and original performance of the machine unchanged in time.

- ☒ Keep all nuts, bolts and screws tight to be sure the equipment is in safe working condition. Regular maintenance is essential for safety and performance.
- ☒ Never store the equipment with fuel in the tank inside a building where vapour may reach a flame or a spark or a source of extreme heat.
- ☒ Allow the engine to cool before storing in an enclosed space.
- ☒ To reduce the fire hazard, keep the engine, exhaust silencer, battery compartment and fuel storage area free of grass, leaves, or excessive grease. Do not leave containers with grass cuttings in rooms.
- ☒ For reasons of safety, do not use the equipment with worn or damaged parts. Parts are to be replaced and not repaired. Use genuine spare parts (blades should always bear the symbol). Parts that are not of the same quality can damage the equipment and be dangerous for your safety.
- ☒ If the fuel tank has to be drained, this should be done outdoors and when the engine is cool.
- ☒ Wear strong work gloves when removing and reassembling the blade.
- ☒ Check the blade's balance after sharpening.
- ☒ Check the self-closing guard and grass-catcher frequently for wear and deterioration.
- ☒ Whenever the machine is to be handled, transported or tilted you must:
 - Wear strong working gloves;

-Grasp the machine at the points that offer a safe grip, taking account of the weight and its distribution.

Blade

Inspection

- ☒ Tilt the mower to the right, so the air cleaner side is up. This will help to prevent fuel leakage and hard starting.

- ☒ Inspect the blade for damage, cracks and excessive rust or corrosion.

A dull blade can be sharpened, but a blade that is excessively worn, bent, cracked, or otherwise damaged must be replaced.

- ☒ A torque wrench must always be used when installing the blade.

Check that the blade bolts are tight.

Removal and installation

If you remove the blade for sharpening or replacement, you will need a torque wrench for installation. Wear heavy gloves to protect your hands.

- ☒ Remove the bolt with a socket wrench. Use a wooden block to prevent the blade from turning when removing the bolt. Then remove the blade.

- ☒ Install the blade using the blade bolt and special washers. Be sure to install the special washers with the concave side toward the blade and the convex side toward the bolt.

- ☒ Tighten the blade bolt with a torque wrench. Use a wooden block to prevent the blade from turning when tightening the bolt.

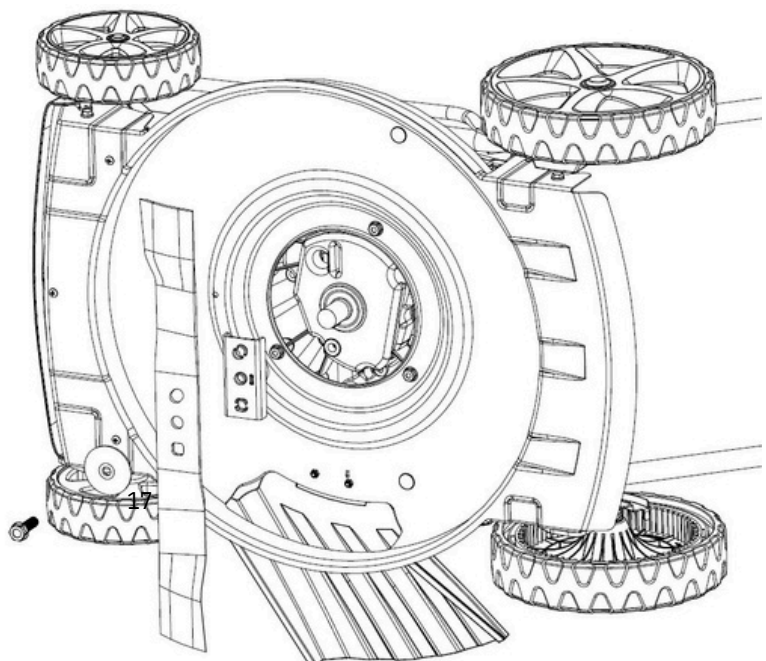

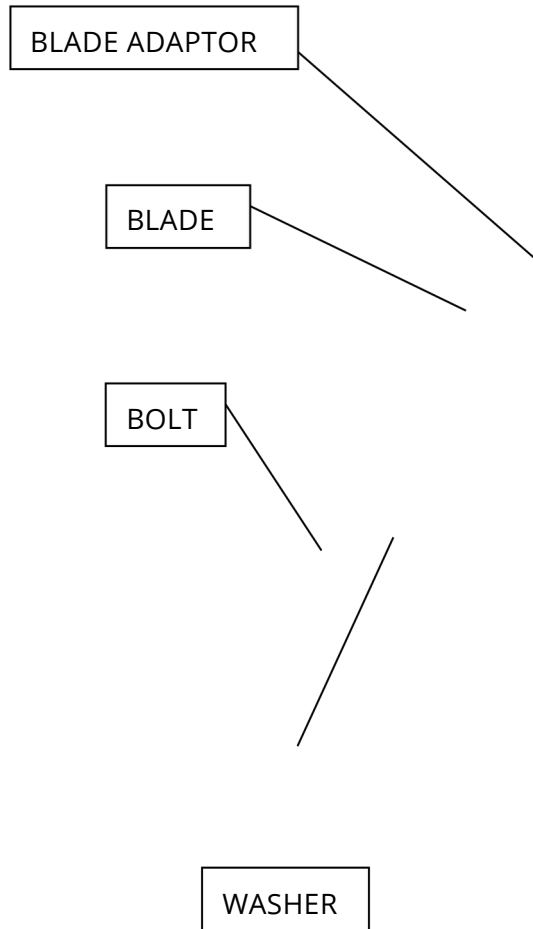

Engine Maintenance

Check Engine Oil Level

Check the engine oil level with the engine stopped and the mower.

- ☒ Remove the oil filler cap, and wipe the dipstick clean.
- ☒ Insert the dipstick into the oil filler neck, but do not screw it in.
- ☒ Check the oil level shown on the dipstick. If near the lower, fill to the upper level with the oil. Do not overfill.
- ☒ Screw in the filler cap securely.

NOTICE Running the engine with a low oil level will cause engine damage.

Change Engine Oil

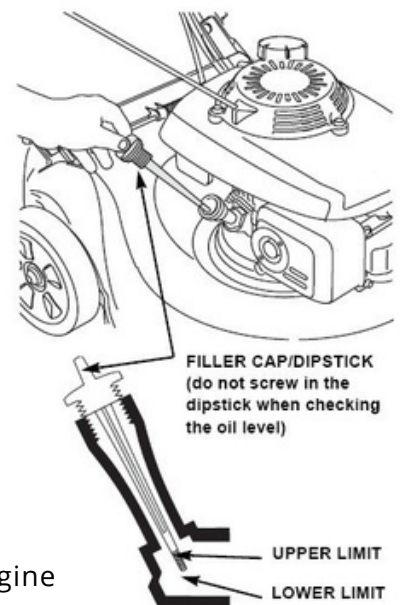

Drain the used oil while the engine is warm. Warm oil drains quickly and completely.

- ☐ Wipe the oil filler area clean, then remove the oil filler cap/dipstick.
- ☐ Place a suitable container next to the mower to catch the used oil, then tilt the mower on its right side. The used oil will drain through the filler neck. Allow the oil to drain completely.

Please dispose of used motor oil and the containers in a manner that is compatible with the environment. We suggest you take it in a sealed container to your local recycling center or service station for reclamation. Do not throw it in the trash, pour it on the ground, or pour it down a drain.

- ☒ Fill with the recommended oil. Do not overfill. Allow a couple of minutes for the oil to settle in the engine, then measure the oil level.

Air Cleaner Service

NOTICE Operating the engine without an air cleaner, or with a damaged air cleaner, will allow dirt to enter the engine, causing rapid engine wear.

- ☒ Press down on the cover tabs and remove the cover.

- ☒ Remove the filter from the air cleaner base..

- ☒ Inspect the filter and foam element, and replace it if damaged.

- ☒ Clean the filter by tapping it several times on a hard surface to remove dirt, or blow compressed air through the air filter from the inside. Never try to brush off dirt; brushing will force dirt into the fibers.

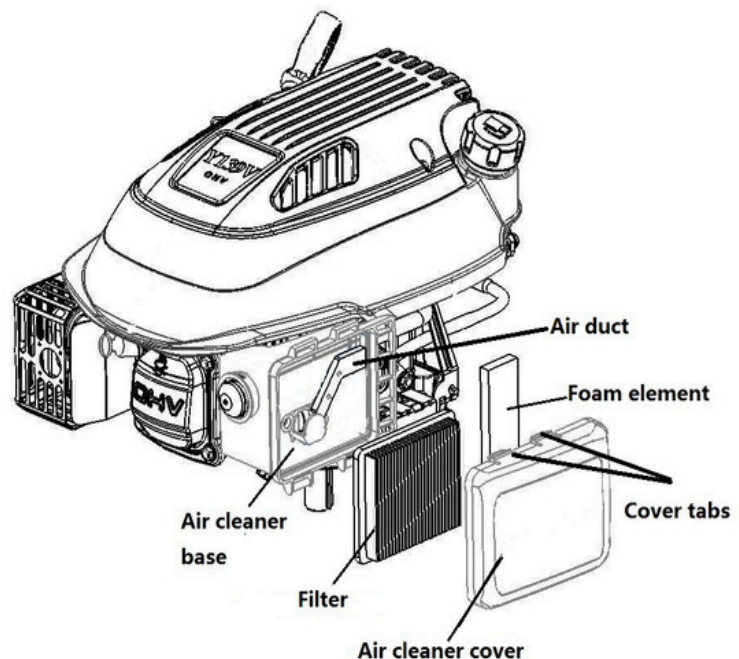

- ☒ Wipe dirt from the inside of the air cleaner base and cover, using a moist rag. Be careful to prevent dirt from entering the air duct that leads to the carburetor.

- ☒ Reinstall the filter and cover.

Spark Plug Service

For good performance, the spark plug must be properly gapped and free of deposits.

- ☒ Disconnect the spark plug cap and remove any dirt from around the spark plug area.

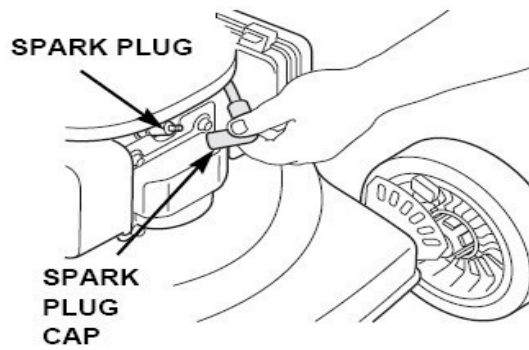

- ☒ Remove the spark plug with a spark plug wrench.

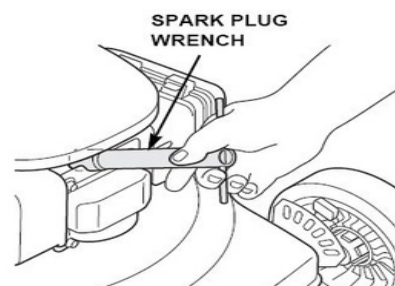

- ☒ Inspect the spark plug. Replace it if the electrodes are worn, or if the insulator is cracked or chipped.

- ☒ Measure the spark plug electrode gap with a suitable gauge. The gap should be 0.028 ~ 0.031 in (0.7 ~ 0.8mm). Correct the gap, if

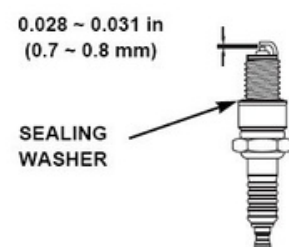

necessary, by carefully bending the side electrode with a suitable tool.

- ☒ Install the spark plug carefully, by hand, to avoid cross-threading.
- ☒ Install the spark plug cap on the spark plug.

NOTICE A loose spark plug can overheat and damage the engine. Over tightening the spark plug can damage the threads in the cylinder head.

The Brake lever Cable Adjustment

- ☒ If the brake lever were loose, you should turn the brake cable adjustment to tighten. (please see the picture)

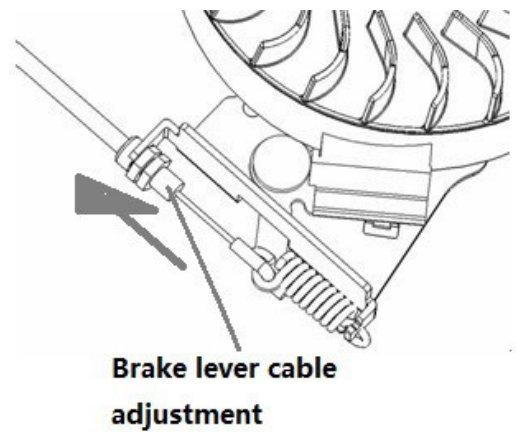

Maintenance Schedule

REGULAR SERVICE PERIOD(4)		Before	First	Every 3	Every 6	Every	Every
ITEM		Each	Month	Months	Months	Year	Two
Perform at every indicated month or operating hour interval, whichever comes first.		Use	or 5 Hrs	or 25 Hrs	or 50 Hrs	or 100 Hrs	Years or 250 Hrs
Engine oil	Check	0					
	Replace		0	0(2)			
Air cleaner	Check		0				
	Replace			0			
Spark plug	Check-adjust					0	
	Replace						0
Flywheel brake pad (A types)	Check					0	
Fuel tank and filter	Clean			0			
Fuel tube	Check	Every 2 years (Replace if necessary)					
Valve clearance	Check-adjust					0	
Combustion chamber	Clean	After every 200 hours					

Trouble Shooting

ENGINE WILL NOT START	Possible Cause	Correction
1. Check fuel.	Out of fuel.	Refuel
	Bad fuel; engine stored without treating or draining gasoline, of refueled with bad gasoline	Drain the fuel tank and carburetor. Refuel with fresh gasoline.

2. Remove and inspect spark plug.	Spark plug faulty, fouled, or improperly gapped.	Replace the spark plug.
	Spark plug wet with fuel (flooded engine).	Dry and reinstall spark plug.
3. Take engine to an authorized our servicing dealer, or refer to shop manual.	Fuel filter clogged, carburetor malfunction, ignition malfunction, valves stuck, etc.	Replace or repair faulty components as necessary.
4. Push the prime button	In cold condition	Push the prime button.

ENGINE LACKS POWER	Possible Cause	Correction
1. check air cleaner	Air cleaner elements clogged.	Clean or replace air cleaner elements
2. Check fuel	Bad fuel; engine stored without treating or draining gasoline, or refueled with bad gasoline.	Drain the fuel tank and clean the carburetor. Refuel with fresh gasoline.
3. Take engine to an authorized our servicing dealer, or refer to shop manual.	Fuel filter clogged, carburetor malfunction, ignition malfunction, valves stuck, etc.	Replace or repair faulty components as necessary.

6. Storage

- ☒ The same petrol must not remain in the tank for more than one month.
- ☒ Thoroughly clean the mower and store it indoors in a dry place.
- ☒ Never store the lawnmower with fuel in the tank inside a building where can reach an open flame or spark.
- ☒ To reduce fire hazard, keep the engine, muffler, battery compartment and fuel storage area free of grass, leaves or excessive grease.
- ☒ If the fuel tank has to be drained, this should be done outdoors.
- ☒ Be careful during adjustment of the machine to prevent entrapment of the fingers between moving blade and fixed parts of the machine.
- ☒ Allow the product to cool for at least 30 minutes before storing.