

**Please, read this manual
carefully before use!**

Owner's Manual



Fast Li-Ion battery charger

KS 22A-FC

KS 40A-FC

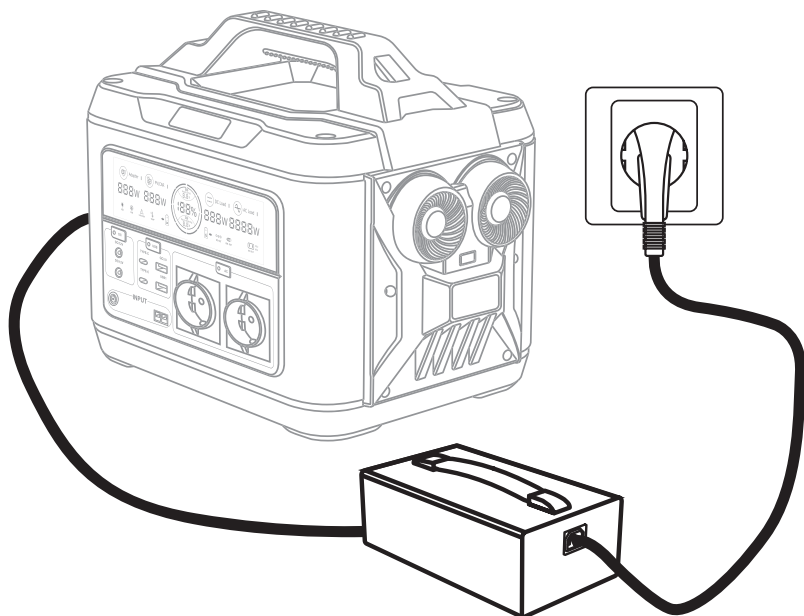



Thank you for your purchase of **Könnner & Söhnen®** products. This manual contains a brief description of safety, use and debugging. More information can be found on the official manufacturer's website in the support section: www.konner-sohnen.com/manuals

You can also go to the support section and download the full version of the manual by scanning the QR code, or on the website of the official importer of Könnner & Söhnen products: www.konner-sohnen.com



We care about the environment, therefore, we consider it expedient to save paper and leave in print a short description of the most important sections.



Be sure to read the full version of the manual before getting started!



Manufacturer reserves the right to make alterations into the generators, which may not be reflected in this manual. Pictures and photos of the product may vary from its actual appearance. At the end of this manual, You may find contact information which you are free to use in case of any issues occurrence.

All data, specified in this operation manual is the most up to date for the moment of its publishing. The current list of service centers you can find at the website of official importer: www.konner-sohnen.com



ATTENTION – DANGER!



Failure to follow the recommendations marked with this sign may lead to serious injury or death of the operator or third parties.



IMPORTANT!



Useful information while operating the machine.

To reduce the risk of battery failure, follow these instructions and those published by the manufacturer of the battery and any equipment you intend to use in the vicinity of the battery.

Review the cautionary markings on these products and on the engine.

- Keep out of reach of children.
- Use only attachments recommended or sold by the battery charger's manufacturer. Use of non-recommended attachments may result in a fire, electric shock or injury.
- Locate the battery charger's power cord so it cannot be stepped on or subjected to damage or stress.
- Do not operate the charger if it has received a sharp blow, been dropped, or otherwise damaged in any way. Take it to a qualified professional for inspection and repair.
- Do not disassemble the charger. Take it to a qualified professional when service or repair is required.
- To reduce the risk of electric shock, unplug the charger from the outlet before attempting any maintenance or cleaning.
- Do not use an extension cord.
- Always charge the battery in a well-ventilated area.
- Do not set the charger on flammable materials, such as carpeting, upholstery, paper, cardboard, etc.
- NEVER smoke or allow sparks or flames in the vicinity of the battery.
- Do not expose the charger to rain or snow.
- When disconnecting the battery charger, pull by the plug, not by the cord. Pulling on the cord may cause damage to the cord or plug.

- Do not operate the charger with a damaged cord or plug.



IMPORTANT!



This charger can be operated from the mains supply with a nominal voltage of 230 V. The mains plug must be inserted into the outlet, and the outlet must be properly installed and grounded under applicable local codes and regulations. The plug contacts must fit in the outlet.

SPECIFICATIONS

2

Model	KS 22A-FC*	KS 40A-FC**
Charge battery type	Li-Ion battery	Li-Ion battery
Output power	500 W	1000 W
Max. output voltage	25.2 V ± 0.2 V	25.2 V ± 0.2 V
Output current	22 A ± 3%	40 A ± 2%
Power efficiency	≥ 85%	≥ 85%
Rated input voltage	200-230 V, AC/50 Hz	200-230 V, AC/50 Hz
Shell material	black aluminium	black aluminium
Operating temperature	-10 °C to +40 °C	-10 °C to +55 °C
Storage temperature	-20 °C to +70 °C	-20 °C to +70 °C
Humidity	5%-80%	5%-90%
Protection	Software over voltage protection Thermal protection Current limiting protection Short circuit protection Reverse polarity protection	Software over voltage protection Thermal protection Current limiting protection Short circuit protection Reverse polarity protection
Dimensions (LxWxH), mm	210x120x73	260x158x91
Net weight, kg	2.2	4.3

*Suitable only for portable power stations KS 1200PS-FC, KS 2200PS-FC.

**Suitable only for portable power stations KS 2200PS-FC.

For Li-Ion batteries only!



IMPORTANT!



Manufacturer reserves the right to make changes and/or improvements in design, components set and technical attributes without notice and without incurring obligation. The pictures in this manual are schematic and may not match the parameters of original product.

USING THE APPLIANCE

3

To charge **the portable power station**, you must first connect the charger to the battery and then plug the charger into a power outlet. Check the indicators on the charger.

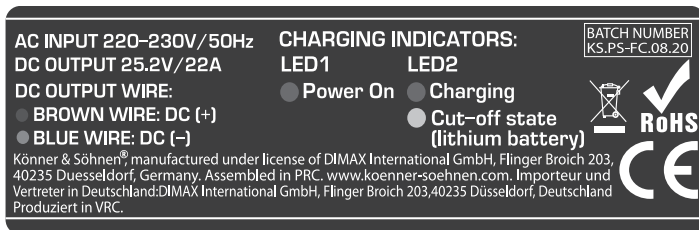

Indicator 1 should light up, which means that the charger is on, and indicator 2, which means that the battery is charging. Indicator 3 (green) means that the battery is not connected to the charger.

Finishing battery charging: first unplug the charger from the power outlet and then from the battery. Fold up the charger.

SECURITY AND MAINTENANCE

4

A minimal amount of care can keep your battery charger working properly for years.

- Occasionally cleaning the case of the charger with a soft cloth will keep the finish shiny and help prevent corrosion.
- Coil the input and output cords neatly when storing the charger. This will help prevent accidental damage to the cords and charger.
- Store the charger unplugged from the AC power outlet in an upright position.
- Store inside, in a cool, dry place. Do not store the clamps clipped together, on or around metal, or clipped to the cables.

WARRANTY SERVICE TERMS

5

The international manufacturer warranty is 1 year. The warranty period starts from the date of purchase. In cases when warranty period is longer than 1 year according to local legislation please contact your local dealer. The Seller which sells the product is responsible for granting the warranty. Please contact the Seller for warranty. Within the warranty period, if the product fails because of defects in the production process, it will be exchanged on the same product or repaired.

All faults caused by the manufacturer during the warranty period will be eliminated free of charge. Warranty repair is carried out only if you have a fully completed warranty card, the Buyer's signature of acceptance of the warranty terms, as well as a document supporting the purchase (cash receipt, sales slip or invoice). In the absence thereof, as well as in the event of errors or corrections not authenticated by the seller's seal or illegible inscriptions in the warranty card or tear-off coupon, no warranty repair is carried out, no objections to quality are accepted and the warranty card is withdrawn by the service center as invalid. The device is accepted for repair clean and full.



EC Declaration of Conformity

Nr. 142

The following products have been tested by us with the listed standards and found in compliance with the European Community Electromagnetic compatibility Directive (EMC) 2014/30/EC.

Manufacturer: DIMAX INTERNATIONAL GmbH
Address: Flinger Broich 203, 40235 Duesseldorf, Germany
Product: Fast Li-Ion battery charger "Könner & Söhnen"
Type / Model: KS 22A-FC, KS 40A-FC, KS 37A-FC

The statement is based on a single evaluation of above mentioned products. It does not imply an assessment of the whole production and does not permit the use of the test lab. logo. The manufacturer should ensure that all product in series production are in conformity with the product sample detailed in this report. The applicant should hold the whole technical report at disposal of the competent all the right.

Applied EC Directives: 2014/30/EC Electromagnetic compatibility Directive (EMC)
Directive 2011/65/EU (RoHS) as last amended by
Directive (EU) 2015/863

Applied Standards: EN 55032:2015
EN 61000-3-3:2014
EN 61000-3-3:2013
EN 55035:2017
IEC 62321-3-1:2013, IEC 62321-5:2013
IEC 62321-4:2013+AMD1:2017, IEC 62321-7-1:2015,
IEC 62321-7-2:2017, IEC 62321-6:2015,
IEC 62321-8:2017



Issued Date: 2022-11-10
Place of issue: Duesseldorf
General director: Fomin P. *P. Fomin*

DIMAX
International
GmbH
Steuer-Nr.: 103 5722 2493
UStIdNr: DE296177274

We DIMAX INTERNATIONAL GmbH hereby declare that specified above conforms covering European Parliament and Council Directives, Electromagnetic compatibility Directive (EMC) 2014/30/EC of 26 February 2014. The CE mark above can be used under the responsibility of manufacturer. After completion of an EC declaration of Conformity and compliance with all relevant EC directives.

CONTACTS

Deutschland:

DIMAX International GmbH
Flinger Broich 203 -FortunaPark-
40235 Düsseldorf, Deutschland
koenner-soehnen.com

Ihre Bestellungen

orders@dimaxgroup.de

Kundendienst, technische Fragen und Unterstützung

support@dimaxgroup.de

Garantie, Reparatur und Service

service@dimaxgroup.de

Sonstiges

info@dimaxgroup.de

Polska:

DIMAX International
Poland Sp.z o.o.

Polska, Warczawska,
306B 05-082 Stare Babice,
info.pl@dimaxgroup.de

Україна:

ТОВ «Техно Трейд КС»,
вул. Електротехнічна 47, 02222,
м. Київ, Україна

sales@ks-power.com.ua
